



A Leading
Marine Company in the
Arab World and Beyond

Profile 2026



A subsidiary of



► **Estithmar**
Holding استثمارة القابضة

4 Groups

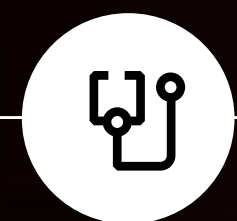

HEALTHCARE

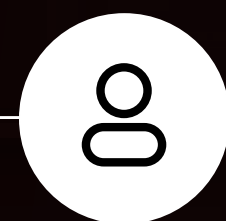

SERVICES

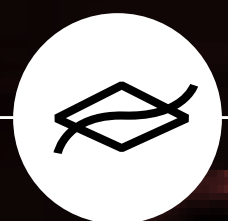

VENTURES

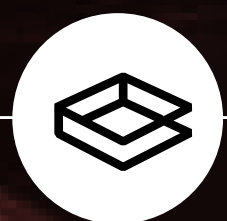

CONTRACTING &
INDUSTRIES

► **elegancia**
marine

Apex
Health

THE VIEW HOSPITAL
KOREAN MEDICAL CENTER
EWS - MEDICAL SERVICES CONSULTANCY
ALGERIAN QATARI GERMAN HOSPITAL
BAGHDAD INTERNATIONAL HOSPITAL

► **elegancia**
services

CATERING
FACILITIES MANAGEMENT
RESOURCES
GABRO
MARINE
ARABIA LIMITED

► **Estithmar**
ventures

AL MAHA ISLAND
MAYSAN DOHA
KATARA HILLS
EQUESTRIAN CLUB
RIXOS BAGHDAD HOTEL & RESIDENCES
ROSEWOOD RANFARU MALDIVES

► **elegancia**
contracting & industries

MEP
LANDSCAPE
CONTRACTING
KITCHENS
CESCO
DATA CENTER
WATER SOLUTIONS
SWITCHGEARS
STEEL
JOINERY
STONES
ARABIA TRADING
MECHANICAL ENGINEERING - KSA



A Leading Marine Company in the Arab World and Beyond

Elegancia Marine, a subsidiary of Estithmar Holding, a customer focused group providing innovative turnkey solutions including value engineering with focus on quality and QHSSE with full transparency.

Our capabilities include Marine Contracting Works, Shipping & Logistics, Ship Building Supervision, Ship Management, Ship Repair & Maintenance and Shipping Agency.

Elegancia Marine owns and operates a diverse fleet of vessels capable to support different types of projects in the marine industry such as transportation, contracting and Oil & Gas.



Key Facts

+30
Marine Units

+15
years of experience

+3 m sqm
Excavation & Reclamation Works

Elegancia Marine delivers turnkey solutions with a focus on value engineering, QHSSE, equality, and transparency. Our expertise includes Marine Contracting, Shipping & Logistics, Shipbuilding Supervision, Ship Management, Repair & Maintenance, and Shipping Agency Services with a diverse fleet of +30 vessels.

Purpose
To add value to
the society for a
better lifestyle

Vision

Creating a brighter
future

Values

Leadership
Quality
Agility
Boldness

Mission

We add exceptional value
to our customers through
the skills and knowledge
of our employees

Guiding Principles

Preserve Corporate Reputation
Develop Future Leaders
Promote Innovation

A subsidiary of

Estithmar
Holding استثمار القابضة

Offshore Marine Services



Bulk Cargo Transport & Logistics Services

We are one of the pioneers in the region by lifting of large COA's, pertaining to bulk cargoes such as quarry, amour rocks, sand, aggregates etc. from port to port within the region on time, every time. Apart from the traditional marine transport services, we also provide door to door logistics such as transport from ex-works to door that includes loading, stowing, discharging, clearance and inland haulage.

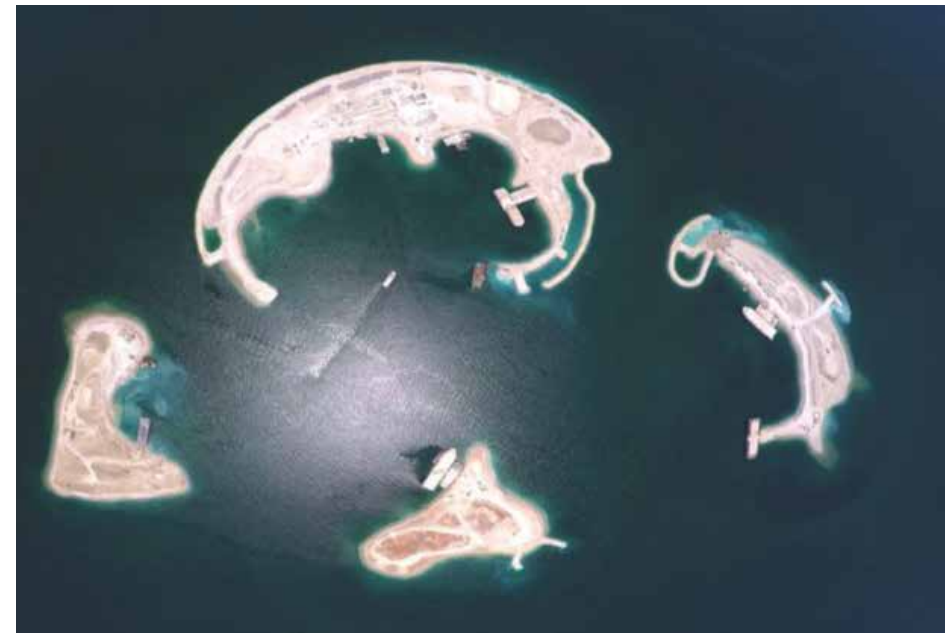

Marine Contracting

We as a Reputable company in Marine Contracting works have the skills, suitable marine assets, and the experience to take over small to medium size marine work projects and we are more than capable to handle diverse specialized fields. Our expertise lies in underwater marine works, building new or maintenance of existing jetties & key walls, Beach construction, Dredging and reclamation, Construction of breakwaters & groins, revetment & related rock works, Sheet piling works, and Installation & Maintenance of Marinas and floating pontoons.



Oil & Gas Offshore Support Services

We provide OSV's to O&G, whether from own vessels or managed one's or through our business partners around the globe to support different activities offshore such as 1) FSO and FPSO, (2) AHTS, DP1 & DP2 for taking up towage contracts and other support services, (3) Jack-up accomodation/work barges and (4) Supporting platforms



Vessel Chartering & Brokering Services

We also pride ourselves to meet the needs of ship owners and charterers by providing them professional chartering and brokerage service prior, during and post fixtures.



Ship Repairs, Maintenance and Drydocking

We offer our customer with technical support by responding quickly to emergency/breakdown situations or on planned maintenance and dry dock supervision work orders.



Ship Management Services

Our extensive expertise offers the marine industry with a first-class vessel management services of the most reliable quality in terms of technical, crew, commercial management and claim handling services.



Marine Procurement

Our team with their extensive experience, know-how and rapport with global suppliers can support the marine industry to quickly source, connect stores and spares which allows you not only save cost, but reduce the lead time and eradicate the hurdles to get the job done.



Ship Building and Supervision

With our experience, and most importantly with our in-house experts we are more than capable to take up shipbuilding projects and supervision services for new builds or conversion.

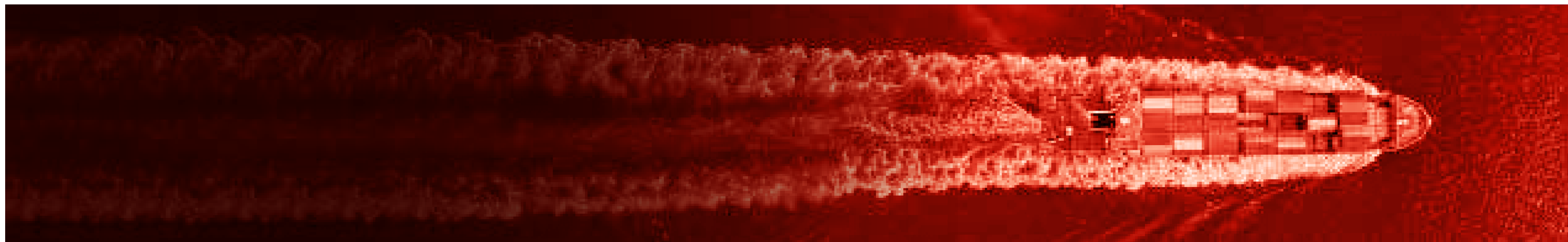

Marine Agency

A division of elegancia marine, committed to provide bundled package of Shipping agency services, ships port call and related husbandry services within the territorial waters of the State of Qatar.

With our knowledge and experience, we serve our clients, charterers, shippers, receivers and brokers of vessels as their local eyes and ears. We deliver our services with full transparency, striving to exceed expectations and focused to provide comprehensive solutions to every complex hurdle.

1. OPA/CPA- Boarding

Appointed by either vessel owner/operator or charterer to look after and protect their interest.

2. Husbandry Agent

Appointed for a service call, bunker call, dry docking, crew changes, procurement etc

3. OPA/CPA- Non-boarding

Appointed as the "Controlling Office" towards a state terminal agent and we control the customer relationship, including pricing, FDA submission and funding. Unable to board vessel due to restrictions from terminal- Mainly on hydrocarbon vessel.

4. Full Agent

Directly appointed and is responsible for registering the vessels with all concerned stake holders, i.e. Port authorities, immigration, customs, shipper/receiver, etc.

5. Ships Agency

Full Port Agent, Owners Protective Agent, Charterers Protective Agent, Cargo Agency or a Husbandry Agent

6. Cargo Related Services

Providing port authorized stevedoring services., Cargo Clearance, Cargo Operation Supervision and Transportation.

7. Ship Husbandry Services

Launch & Boat services, CTM, ship spares, supplies, and provisions, bunkers, rental of MHE, Marine Surveyors-Inspection, Loss Adjustors and P&I Club Services.

8. Crew Related Services

Crew Changes, Crew Transport, Crew Medical and Certification.

A subsidiary of

Estithmar
Holding استثمارة القابضة



Certificates

Marina Industries Association
2024

Elegancia Marine Offshore Services

is a proud member of the **Marina Industries Association**

Logos: Marina Training Institute, Marine Jobs, Gold Anchor, Superyacht, International CleanMarina, mymarina.

TUVNORD
Certificate
Management system as per
ISO 9001:2015

ELEGANCIA MARINE OFFSHORE SERVICES W.L.L.
13Bteen Tower, Building No.230, Street No.303, Zone 69
P.O. Box 24519, Lusal City, QATAR

Provision of Conceptual Design for Ship Building, Ship Management, Marine Services, Recruitment and Placement of Seafarers.

Logos: IAF, DAKS.

TUVNORD
Certificate
Management system as per
ISO 14001:2015

ELEGANCIA MARINE OFFSHORE SERVICES W.L.L.
13Bteen Tower, Building No.230, Street No.303, Zone 69
P.O. Box 24519, Lusal City, QATAR

Provision of Conceptual Design for Ship Building, Ship Management, Marine Services, Recruitment and Placement of Seafarers.

Logos: IAF, DAKS.

TUVNORD
Certificate
Management system as per
ISO 45001:2018

ELEGANCIA MARINE OFFSHORE SERVICES W.L.L.
13Bteen Tower, Building No.230, Street No.303, Zone 69
P.O. Box 24519, Lusal City, QATAR

Provision of Conceptual Design for Ship Building, Ship Management, Marine Services, Recruitment and Placement of Seafarers.

Logos: IAF, DAKS.

Certificate of Registration

This is to certify that **ELEGANCIA MARINE OFFSHORE SERVICES W.L.L.**
THE BIRTHEEN TOWER, BUILDING NO. 230, STREET 303, ZONE 69,
PO BOX 24519, LUSAL CITY, QATAR

has been assessed by RSBV and found to comply with the requirements of **ISO 13687-1:2017**
Tourism and related Services

For the following activities:
**YACHT AND MARINA MANAGEMENT, WATER SPORTS,
AND MARINE TOURISM SERVICES.**

Certificate Number / Certificate No. : **RSBV-3403-XXXX**

Valid until: 30/03/2024
Date of Issue: 03/03/2023
Date of Renewal: 03/03/2025
Date of Expiry: 03/03/2027

Royal Stancert B.V.
INC 0240 1336 200

BIMCO
Certificate of Membership

We hereby certify that **Elegancia Marine Offshore Services** is a registered member (1603305) of BIMCO for **2024**

David Looney
Secretary General & CEO, BIMCO

DOCUMENT OF COMPLIANCE
Certificate No. **00074/18**

Issued under the provisions of the **INTERNATIONAL CONVENTION FOR THE SAFETY OF LIFE AT SEA 1974**, as amended

Under the authority of the Government of St. Kitts & Nevis by Indian Register of Shipping
Name and address of the Company: **Elegancia Marine Offshore Services
Floor 2, Building No.230, Al Sheehan Ave #
Tower 230, Doha
State of Qatar**

Company Identification number: **000499**

THIS IS TO CERTIFY THAT the safety management system of the Company has been audited and that it complies with the requirements of the International Management Code for the Safe Operation of Ships and for Pollution Prevention (ISM Code) for the types of ships listed below (delete as appropriate):

- Passenger Ship
- Passenger High-speed craft
- Organic high-speed craft
- Bulk Carrier
- Oil-Tanker
- Chemical-Tanker
- Gas-Carrier
- Mobile Offshore-Unit/Platform
- Other Cargo Ship

This Document of Compliance is valid until **23/07/2024** 00:00/hrs/yyyy, subject to periodical verification.
Completion date of the verification on which this certificate is based: **20/07/2024** 00:00/hrs/yyyy.
Issued on: **MM/YY/2024** 00:00/hrs/yyyy.

Official Seal: Indian Register of Shipping

ICV Scorecard Certificate

This Certificate is issued to: **Elegancia Marine Offshore Services W.L.L.**
Commercial Registration Number: 71175 | Address: 230 FLOOR, THE ELEGANCIA TOWER -DCM- 18 (24th BR), STREET 4303, Doha, P.O. Box 24519, LUSAL CITY, QATAR | P.O. BOX 24519

ICV Certification Details	ICV Score & Contribution
Certificate Number: 10001801	ICV Score: 30.01%
Category: Marine Services and Partners	A. Goods & Services: 12.00%
Issue Date: 18 July 2023	B. Workforce Training: 6.00%
Expiry Date: 18 July 2024	C. Supplier Development: 6.00%
Download Date: 18 July 2023	D. Investments in Fixed Assets: 17.00%

On behalf of Elegancia Marine Offshore Services W.L.L. (Signature: David Looney)
On behalf of Moore Stephens and Partners W.L.L. (Signature: David Looney)

Notes: 1) The ICV Certificate is an indicator from Moore Stephens and Partners, a 3rd party report dated 18/07/2023 and should be used in conjunction with the company's own internal findings report relevant to the ICV score as the full ICV report. 2) The full ICV report is available on request from Moore Stephens and Partners and Elegancia Marine Offshore Services W.L.L. dated 18/07/2023. Moore Stephens and Partners does not accept or assume any liability or responsibility for or to be held for any and all consequences if it is deemed by anyone, other than the intended recipient, to be relevant to the engagement. 3) In the event any of the information on the ICV Certificate requires further verification, contact should be made of its Terms.



OUR PROJECTS



BANANA ISLAND

Marine Works

Scope: Development Management, Design & Build

BUA: 67,727 m²

Location: Doha, Qatar



LUSAIL RECLAIMED ISLANDS

Reclamation & Marine Works

Scope: Design & Build

BUA: 850,000 m²

Location: Sumaisima, Qatar



NEW LUSAIL ISLAND

Scope: Design & Build

BUA: 850,000 m²

Location: Lusail North, Qatar



AL DAKHIRA MARINA

Scope: Build

BUA: 35,853.36 m²

Location: Al Dakhira Port, Qatar



AL KHOR MARINA

Scope: Build

BUA: 112,267.36 m²

Location: Al Khor Port, Qatar



WALDORF ASTORIA MALDIVES ITHAAFUSHI

Scope: Design & Build

BUA: 92,000 m²

Location: Maldives



SHERATON HOTEL

Scope: Renovation

BUA: 178,950 m²

Location: Doha, Qatar



THE BASE PROJECT

Scope: Excavation and reclamation works for a new Navy Coast Guard Base

BUA: 170,000 m²

Location: Sumaisima, Doha Qatar

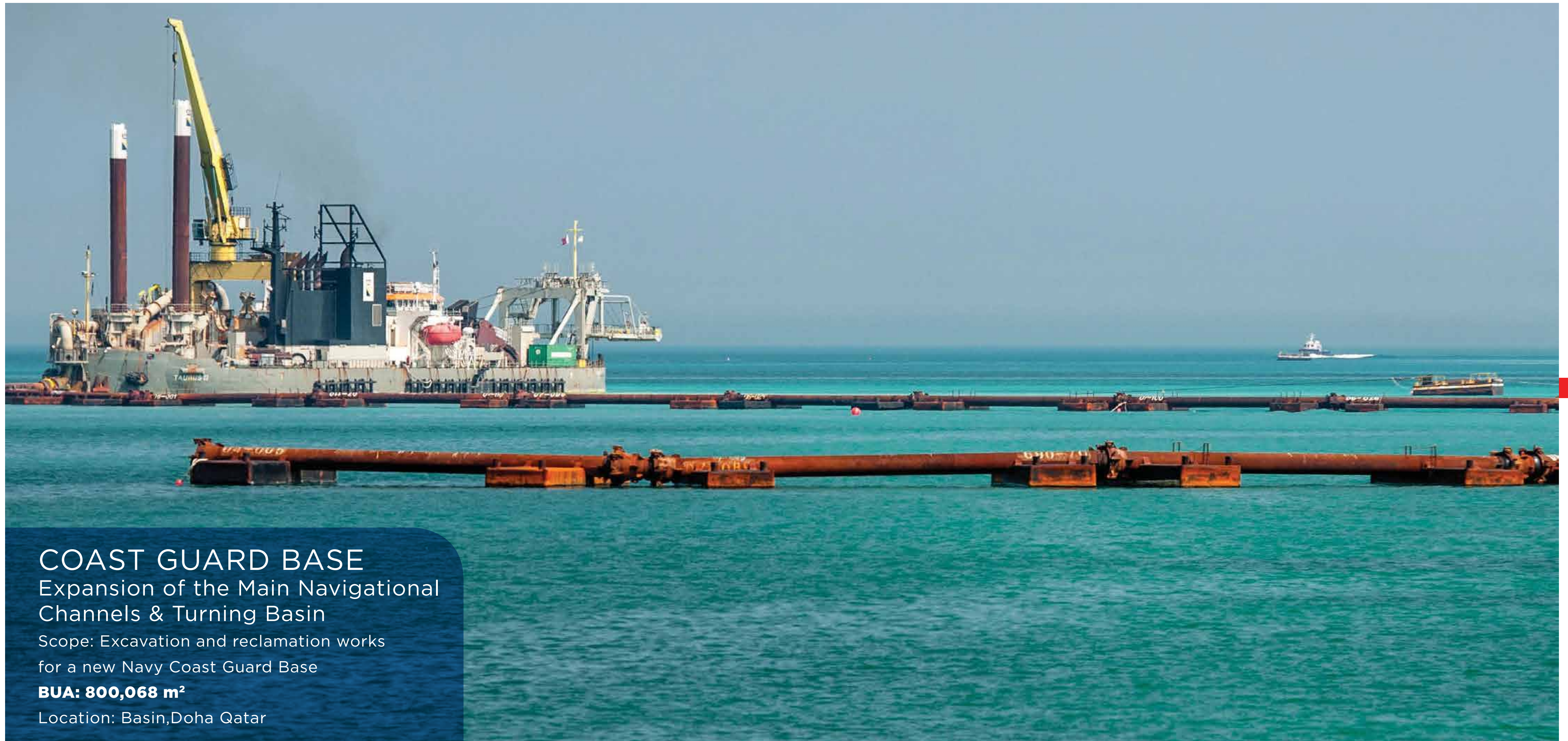

COAST GUARD BASE

Expansion of the Main Navigational Channels & Turning Basin

Scope: Excavation and reclamation works for a new Navy Coast Guard Base

BUA: 800,068 m²

Location: Basin, Doha Qatar

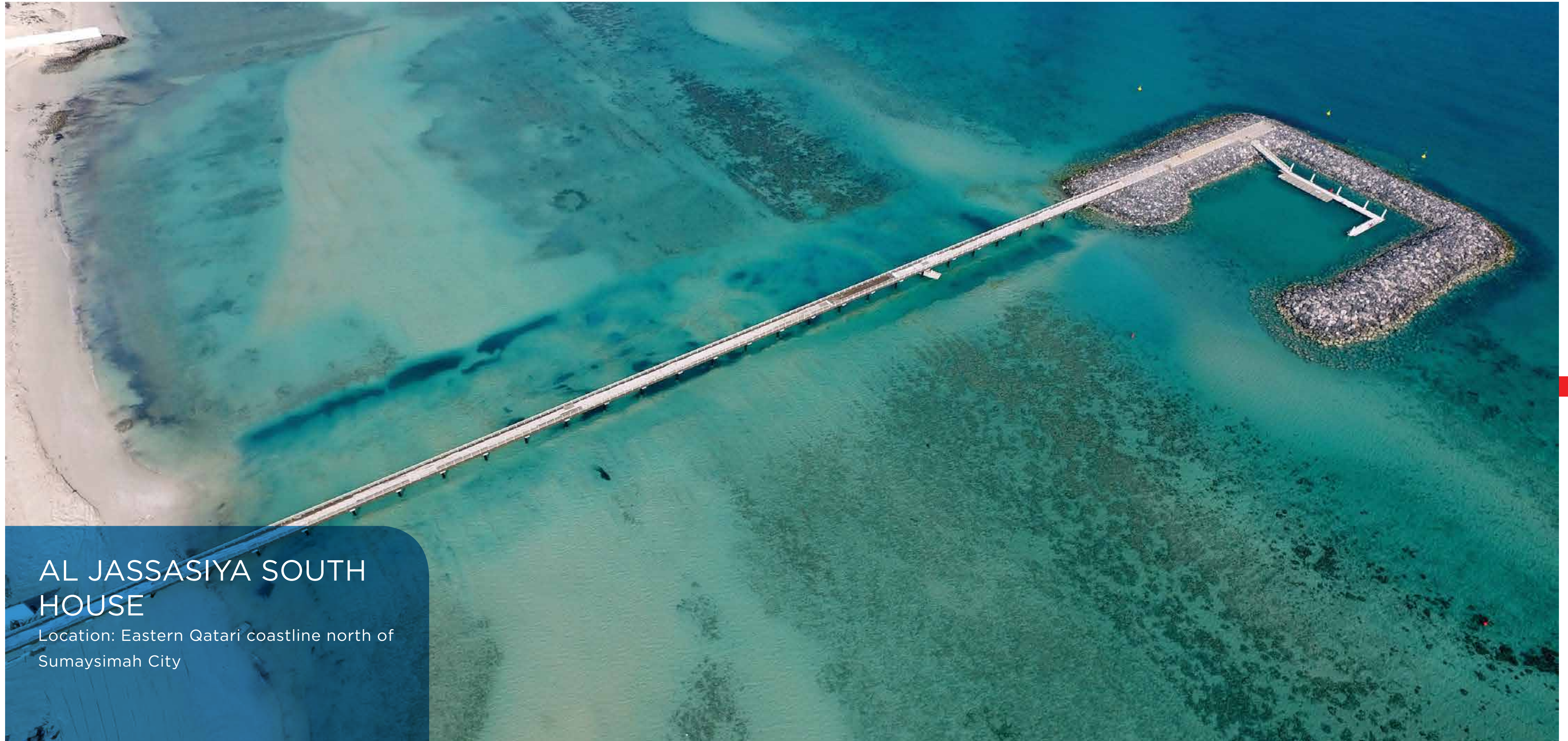

AL JASSASIYA SOUTH HOUSE

Location: Eastern Qatari coastline north of Sumaysimah City

the island project marine works

Total Excavated Volume: 2 million m²



Completed Marina



Marina CGI



Excavation of Swimmable Area



Excavation of Basin



Overwater Villas

The Fleet at A Glance



OWNED VESSELS & MANAGED VESSELS

**PEGASUS XX
(Tugboat)**

LOA: 32.00 m
 Breadth: 9.14 m
 Depth: 4.20 m
 Draft: 3.50 m
 Capacity : 3200 HP

**GEWAN
(Cutter Suction
Dredger)**

LOA: 43.50 m
 Breadth: 4.67 m
 Depth: 2.97 m

**RIGEL X
(Barge)**

LOA: 106.24 m
 Breadth: 27.43 m
 Depth: 6.71 m
 Draft: 5.23 m
 Capacity : 11155 T

**PHANTOS XX
(Tugboat)**

LOA: 27.49 m
 Breadth: 9.14 m
 Depth: 4.16 m
 Draft: 3.50 m
 Capacity : 3200 HP

**PROCYON XX
(Tugboat)**

LOA: 28.00 m
 Breadth: 8.60 m
 Depth: 4.12 m
 Draft: 3.50 m
 Capacity : 2034 HP

**SIRIUS X
(Barge)**

LOA: 96.56 m
 Breadth: 30.48 m
 Depth: 6.10 m
 Draft: 3.80 m
 Capacity : 11437 T

**ATLAS V
(Barge)**

LOA: 82.30 m
 Breadth: 21.40 m
 Depth: 4.90 m
 Draft: 3.80 m
 Capacity : 5500 T

**ARIES V
(Barge)**

LOA: 82.30 m
 Breadth: 21.40 m
 Depth: 4.90 m
 Draft: 3.80 m
 Capacity : 5500 T

**ARCHER V
(Barge)**

LOA: 76.20 m
 Breadth: 24.38 m
 Depth: 4.88 m
 Draft: 3.62 m
 Capacity : 4905 T

ALLHUDDAD

LOA: 64.0m
 Breadth: 14.63
 Depth: 4.5 M
 Draft: Mimimum) 1.68 M
 Capacity : 2587.8t

**SCORPIO D
(Barge)**

LOA: 87.78 m
 Breadth: 24.38 m
 Depth: 5.49 m
 Draft: 4.27 m
 Capacity : 7130 T

**HAMAL II
(Spud Barge)**

LOA: 54.86 m
 Breadth: 18.29 m
 Depth: 3.96 m
 Draft: 3.22 m
 Capacity : 2406 T

**CAPELLA III
(Spud Barge)**

LOA: 54.86 m
 Breadth: 18.29 m
 Depth: 3.96 m
 Draft: 3.22 m
 Capacity : 2406 T

**ANTARES IV
(Spud Barge)**

LOA: 54.86 m
 Breadth: 18.29 m
 Depth: 3.96 m
 Draft: 3.22 m
 Capacity : 2406 T

SHWEMSA

LOA: 68 m
 Breadth: 16
 Depth: 4.80 m
 Draft: Mimimum) 1.32 m
 Capacity : 2199.2T

**ALTAIR I
(Spud Barge)**

LOA: 76.20 m
 Breadth: 24.38 m
 Depth: 4.88 m
 Draft: 3.62 m
 Capacity : 4900 T

**SEA GALAXY
(Tugboat)**

LOA: 23.50 m
 Breadth: 7.31 m
 Depth: 3.20 m
 Draft: 2.69 m
 Capacity : 1300 HP

**POLLUX XX
(Tugboat)**

LOA: 28.93 m
 Breadth: 9.50 m
 Depth: 4.20 m
 Draft: 3.20 m
 Capacity : 3200 HP

**PISCES XX
(Tugboat)**

LOA: 32.00 m
 Breadth: 9.14 m
 Depth: 4.20 m
 Draft: 3.50 m
 Capacity : 3200 HP

ASSOMPTION STAR

LOA: 88.58 m
 Breadth: 16.80
 Depth: 4.20 m
 Draft: Mimimum) 2.80 m
 Capacity : 3014.00T



ANNEX



PEGASUS XX

TUG BOAT

PRINCIPAL PARTICULARS

YEAR OF BUILT	2014
BUILDER	MALAYSIA
FLAG	PANAMA
CLASS	RINA
IMO NO	9519420
CALL SIGN	HP8137
GRT	298 TONS
NRT	90 TONS
ACCOMMODATION	14 MEN

MACHINERY

MAIN ENGINES	CUMMINS
POWER	2 X 1600 BHP
GENERATORS	CUMMINS (2 X 100 KVA)
PROPELLERS	2 X 4
BLADES	
GEAR BOX	REINTJES
OILY WATER SEPARATOR	YES
SEWAGE PLANT	YES
BOW THRUSTER	NO
BOLLARD PULL	41 TONS

PRINCIPAL DIMENSIONS

LOA	32 MTRS
BREADTH	9.14 MTRS
DEPTH	4.20 MTRS
DRAFT	3.5 MTRS

TANK CAPACITIES

DIESEL FUEL OIL	212.28 TONS
POTABLE WATER	32.67 TONS
BALLAST	22.94 TONS
LUB OIL	3.33 TONS

CONSUMPTION

FUEL TYPE	MGO
DAILY CONSUMPTION :	
FREE RUNNING	4,000 LTRS
TOWING EMPTY BARGE	4,500 LTRS
TOWING LOADED BARGE	4,800 LTRS
IDLE	500 LTRS

SPEED

MAX. SPEED	10 KNOTS
TOWING SPEED :	
ECO SPEED	3.5 KNOTS
FULL SPEED	4.5 KNOTS

NAVIGATION EQUIPMENT

AUTOPILOT	YES
GPS	YES
RADAR	YES
ECHO SOUNDER	YES
VHF RADIO	YES
SSB RADIO	YES
EPIRB	YES
NAVTEX	YES
INMARSAT-C	YES
GMDSS	YES
MAGNETIC COMPASS	YES
AIS	YES

DECK EQUIPMENT

ANCHOR WINDLASS	YES
TOWING WINCH	YES
TOWING HOOK	40 TON
CAPACITY	

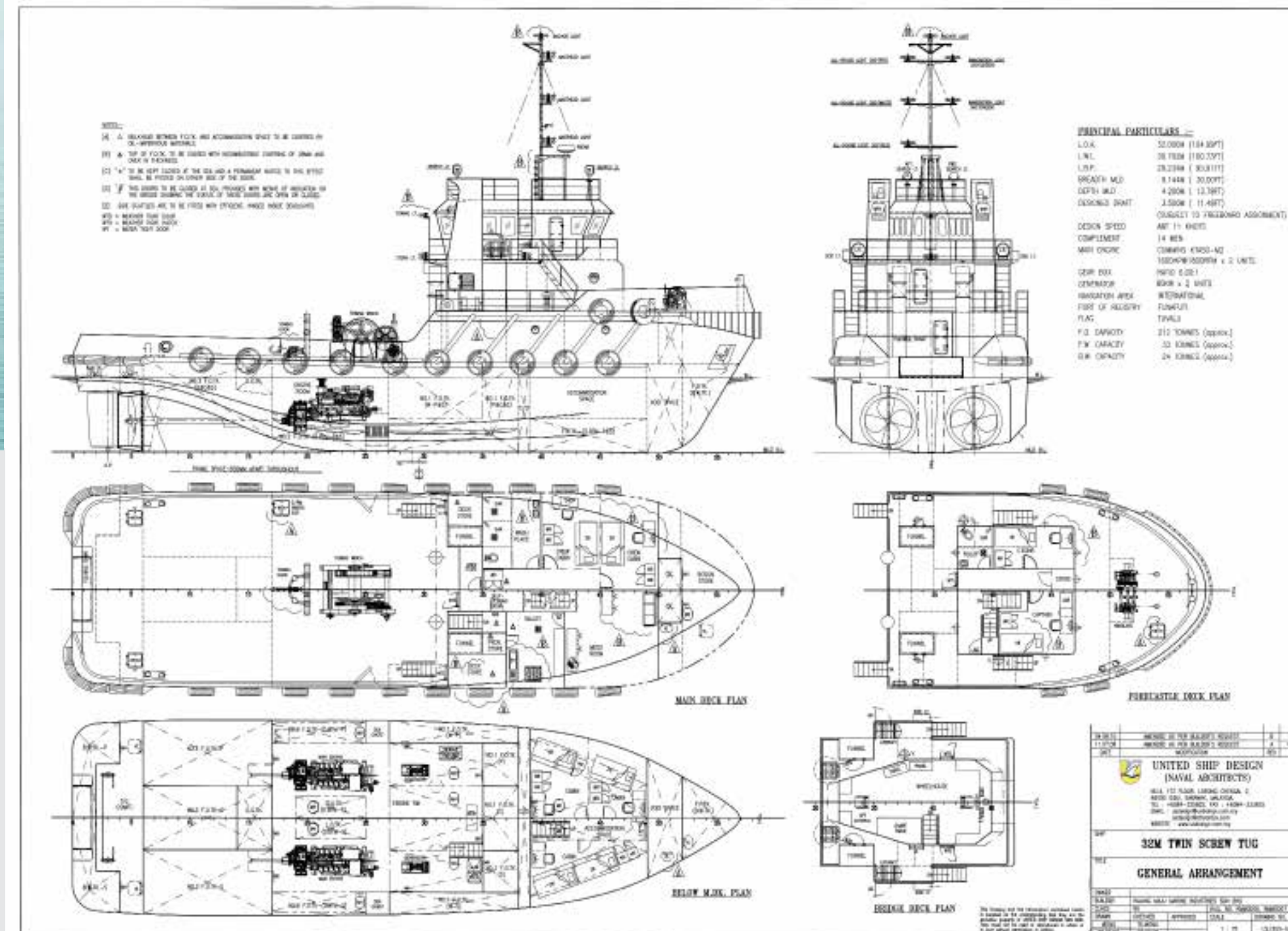



SIRIUS X

FLAT TOP BARGE

PRINCIPAL PARTICULARS

VESSEL TYPE	FLAT TOP BARGE
SHAPE	BOX
YEAR OF BUILT	2006
PLACE OF BUILT	CHINA
FLAG	PANAMA
CLASS	RINA
GRT	4,950 TONS
NRT	1,485 TONS

PRINCIPAL DIMENSIONS

LOA	96.56 MTRS
BREADTH MOULDED	30.48 MTRS
DEPTH MOULDED	6.10 MTRS
DRAFT MOULDED	4.70 MTRS

CARGO CAPACITY

DEADWEIGHT	10,300 TONS
SUMMER TONNAGE	10,000 TONS
TROPICAL TONNAGE	10,299 TONS

DECK PARTICULARS

CLEAR DECK AREA	86.5 MTRS x 24.50
MTRS	
DECK STRENGTH	15 T/M2

OTHER PARTICULARS

DOORS	BOTH SIDES,
MIDSHIP	
SIDEWALL HEIGHT	4 MTRS
ANCHOR	YES - AFT

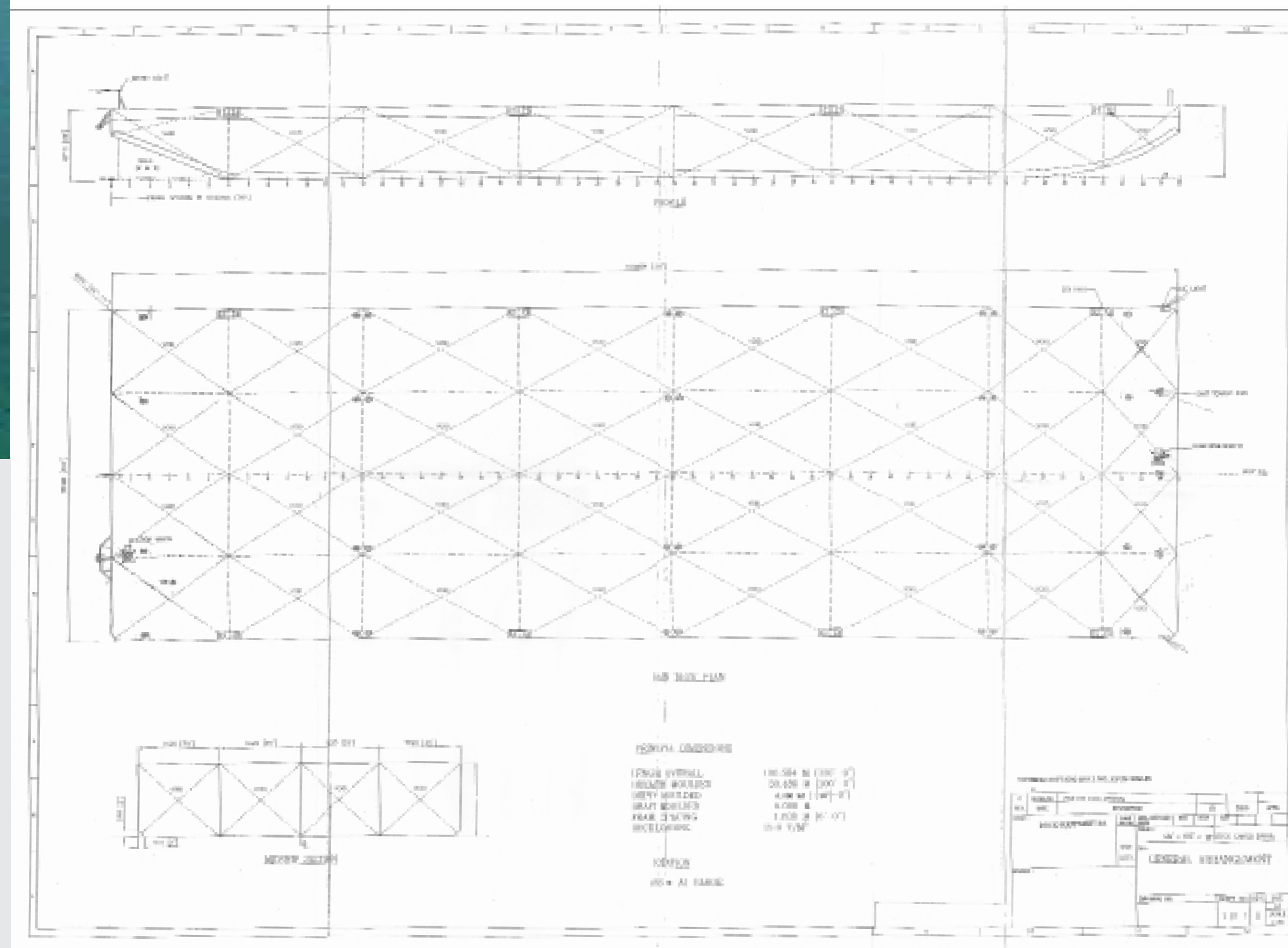



SCORPIO D

FLAT TOP BARGE

PRINCIPAL PARTICULARS

VESSEL TYPE	CARGO BARGE
SHAPE	SHIP SHAPE
YEAR OF BUILT	2004
PLACE OF BUILT	INDONESIA
FLAG	PANAMA
CLASS	IRS
GRT	2,938 TONS
NRT	881 TONS

PRINCIPAL DIMENSIONS

LOA	87.78 MTRS
BREADTH MOULDED	24.384 MTRS
DEPTH MOULDED	5.486 MTRS
DRAFT MOULDED	4.272 MTRS

CARGO CAPACITY

DEADWEIGHT	7,130 TONS
SUMMER TONNAGE	5,600 TONS
TROPICAL TONNAGE	7,100 TONS

DECK PARTICULARS

CLEAR DECK AREA	80 MTRS x 22 MTRS
DECK STRENGTH	8 T/M2

OTHER PARTICULARS

DOORS	BOTH SIDES, MIDSHIP
SIDEWALL HEIGHT	2.2 MTRS
ANCHOR	NO

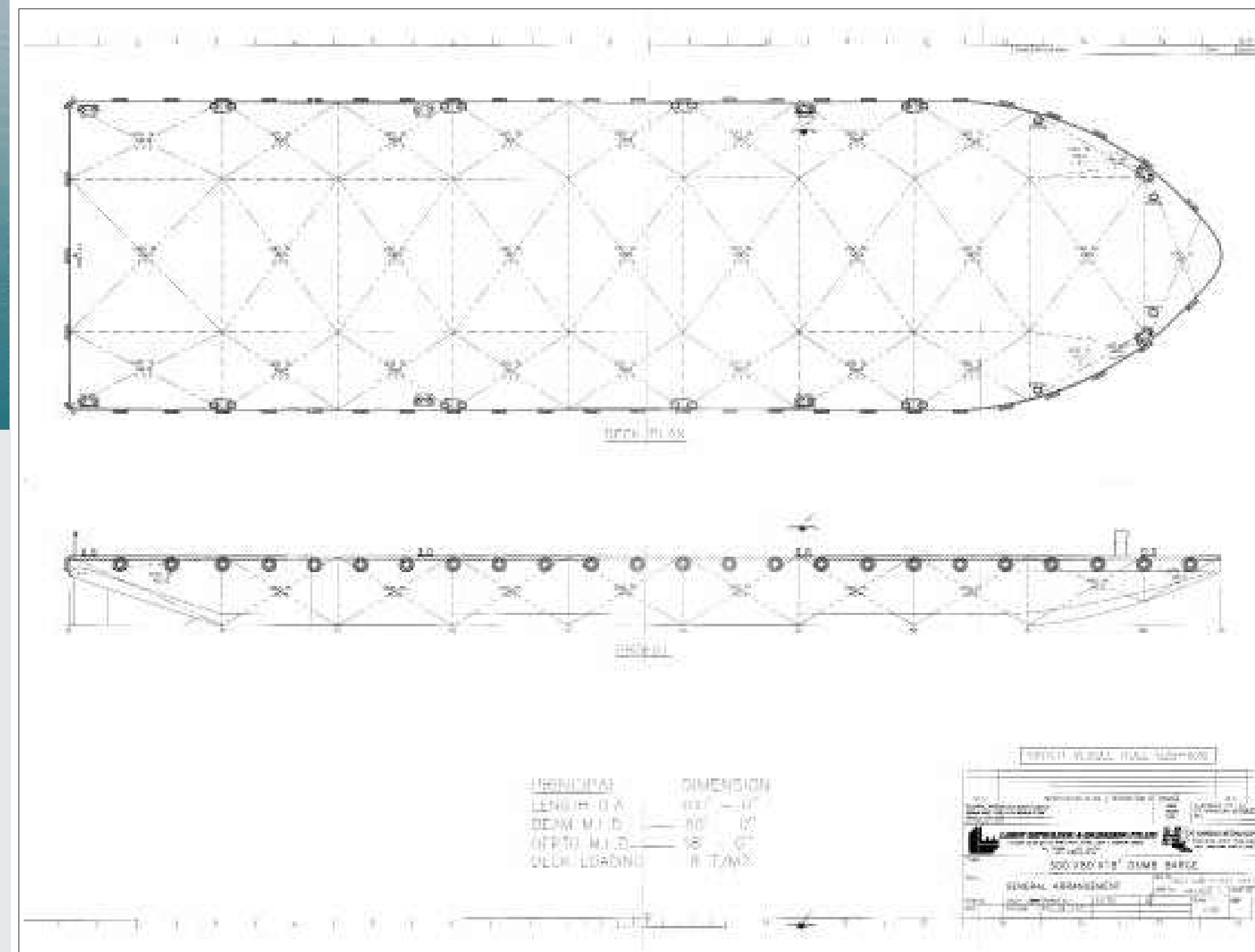



ALTAIR I

SPUD BARGE

PRINCIPAL PARTICULARS

VESSEL TYPE	SPUD BARGE
SHAPE	BOX
YEAR OF BUILT	2014
PLACE OF BUILT	CHINA
FLAG	PANAMA
CLASS	IRS
GRT	2326 TONS
NRT	697 TONS
DEADWEIGHT	4900 TONS

PRINCIPAL DIMENSIONS

LOA	76.20 MTRS
BREADTH MOULDED	24.38 MTRS
DEPTH MOULDED	4.88 MTRS
DRAFT MOULDED	3.62 MTRS
LIGHT DRAFT	1.20 MTRS

BARGE MOORING SYSTEM

SPUDS	4 NOS
SPUD DIAMETER	120 CMTRS
SPUD LENGTH	18 MTRS
4 POINT MOORING SYSTEM	YES
SPUD WINCHES	4 X 15 TONS
WINCHES SPECIFICATION OF SPUDS	ELECTRO HYDRAULIC SINGLE DRUM WINCHES
ANCHOR	4 NOS - 3,000 KGS EACH
ANCHOR WINCHES	4 X 10 TONS
ANCHOR WIRE LENGTH	200 MTRS
POWER GENERATOR	2 X AC GENERATOR @ 1500 RPM
POWER GENERATOR CAPACITY	250 KVA + 80 KVA

DECK PARTICULARS

DECK STRENGTH	20 T/M2
DECK AREA	1857 M2

OTHER PARTICULARS

FRESH WATER TANK	10 TONS
------------------	---------

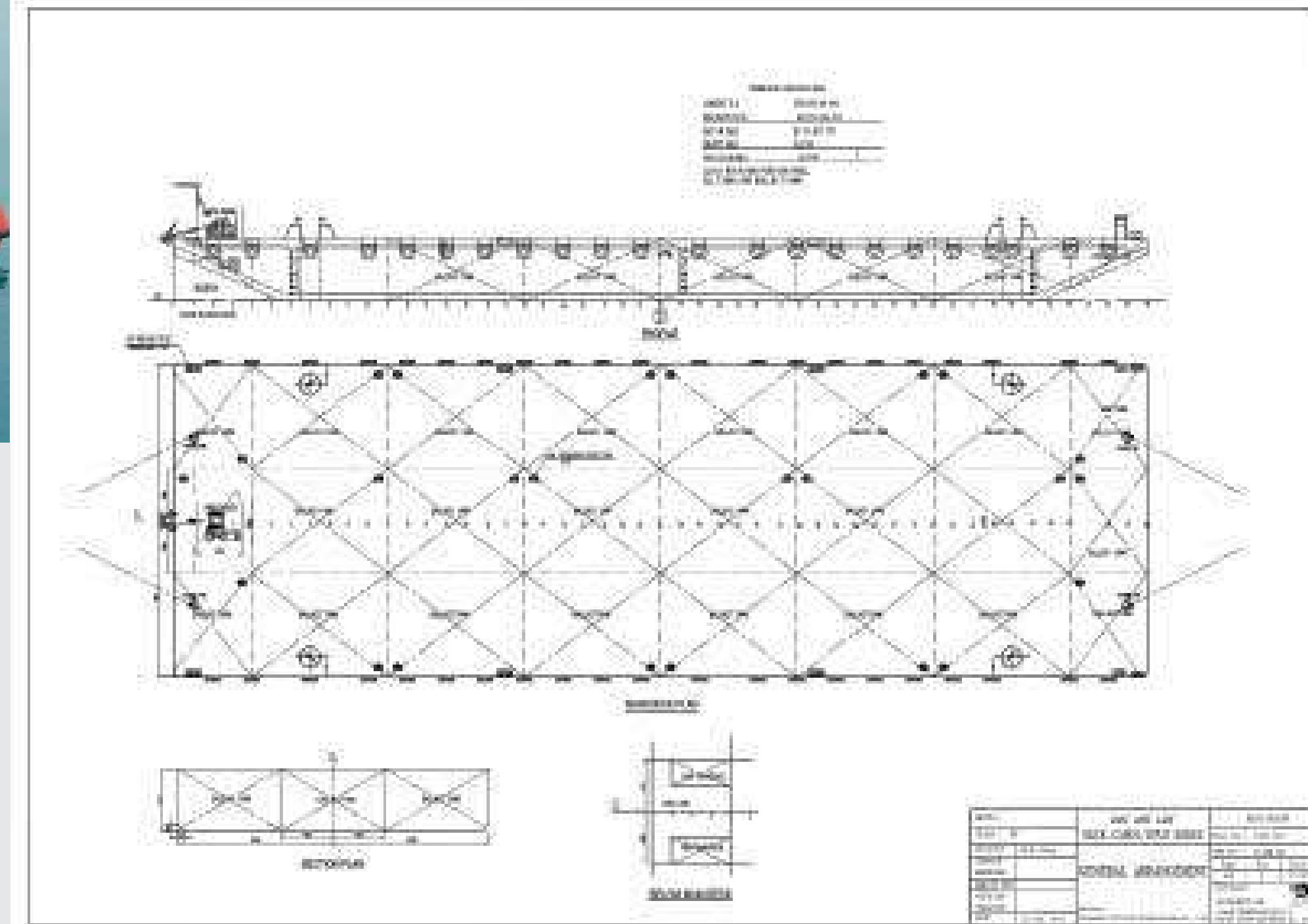



ATLAS V

FLAT TOP BARGE

PRINCIPAL PARTICULARS

VESSEL TYPE	FLAT TOP
BARGE	
SHAPE	SHIP SHAPE
YEAR OF BUILT	2013
PLACE OF BUILT	CHINA
FLAG	PANAMA
CLASS	RINA
GRT	2,144 TONS
NRT	643 TONS

PRINCIPAL DIMENSIONS

LOA	82.30 MTRS
BREADTH MOULDED	21.40 MTRS
DEPTH MOULDED	4.90 MTRS
DRAFT MOULDED	3.20 MTRS

CARGO CAPACITY

DEADWEIGHT	5,500 TONS
SUMMER	5,000 TONS
TROPICAL	5,100 TONS

DECK PARTICULARS

CLEAR DECK AREA	73.2 MTRS X 19.1 MTRS
DECK STRENGTH	7T/M2

OTHER PARTICULARS

DOORS	BOTH SIDES, MIDSHIP
SIDEWALL HEIGHT	4 MTRS
ANCHOR	YES - FORWARD

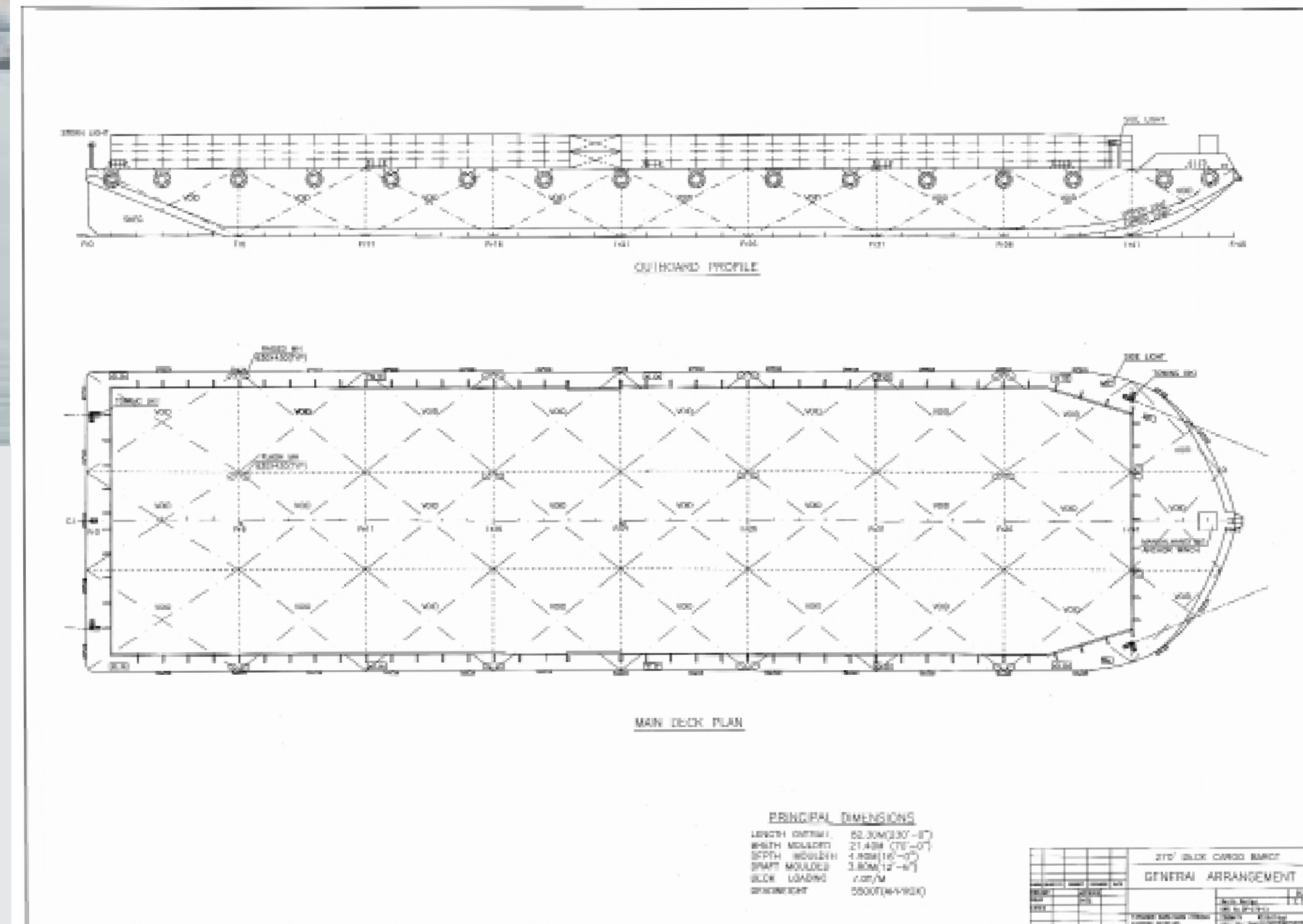



SEA GALAXY

TUG BOAT

PRINCIPAL PARTICULARS

YEAR OF BUILT	2013
BUILDER	MALAYSIA
FLAG	QATAR
CLASS	RINA
IMO NO	9694294
CALL SIGN	A7EM
GRT	146 TONS
NRT	44 TONS
ACCOMMODATION	10 MEN

MACHINERY

MAIN ENGINES	
YANMAR	
POWER	2 X 650
BHP	
GENERATORS	

PROPELLERS	YANMAR
GEAR BOX	(2 X 37.54 HP)
OILY WATER SEPARATOR	2 X 4 BLADES
REINTJES	YES
SEWAGE PLANT	YES
BOW THRUSTER	NO
BOLLARD PULL	20 TONS

PRINCIPAL DIMENSIONS

LOA	23.50 MTRS
BREADTH	7.31 MTRS
DEPTH	3.20 MTRS
DRAFT	2.69
MTRS	

TANK CAPACITIES

DIESEL FUEL OIL	81.36 TONS
POTABLE WATER	25.88 TONS
BALLAST	46.08 TONS
LUB OIL	0.49 TONS

CONSUMPTION

FUEL TYPE	MDO
DAILY CONSUMPTION:	
FREE RUNNING	2,900 LTRS
TOWING EMPTY BARGE	3,200 LTRS
TOWING LOADED BARGE	3,500 LTRS
IDLE	200 LTRS

SPEED

MAX. SPEED	10 KNOTS
TOWING SPEED:	
ECO SPEED	2.5 KNOTS
FULL SPEED	3.0 KNOTS

DECK EQUIPMENT

ANCHOR WINDLASS	YES
TOWING WINCH	NONE
TOWING HOOK	20 TON

NAVIGATION EQUIPMENT

AUTOPILOT	NO
GPS	YES
RADAR	YES
ECHO SOUNDER	YES
VHF RADIO	YES
SSB RADIO	YES
EPIRB	YES
NAVTEX	YES
INMARSAT-C	YES
GMDSS	YES
MAGNETIC COMPASS	YES
AIS	YES

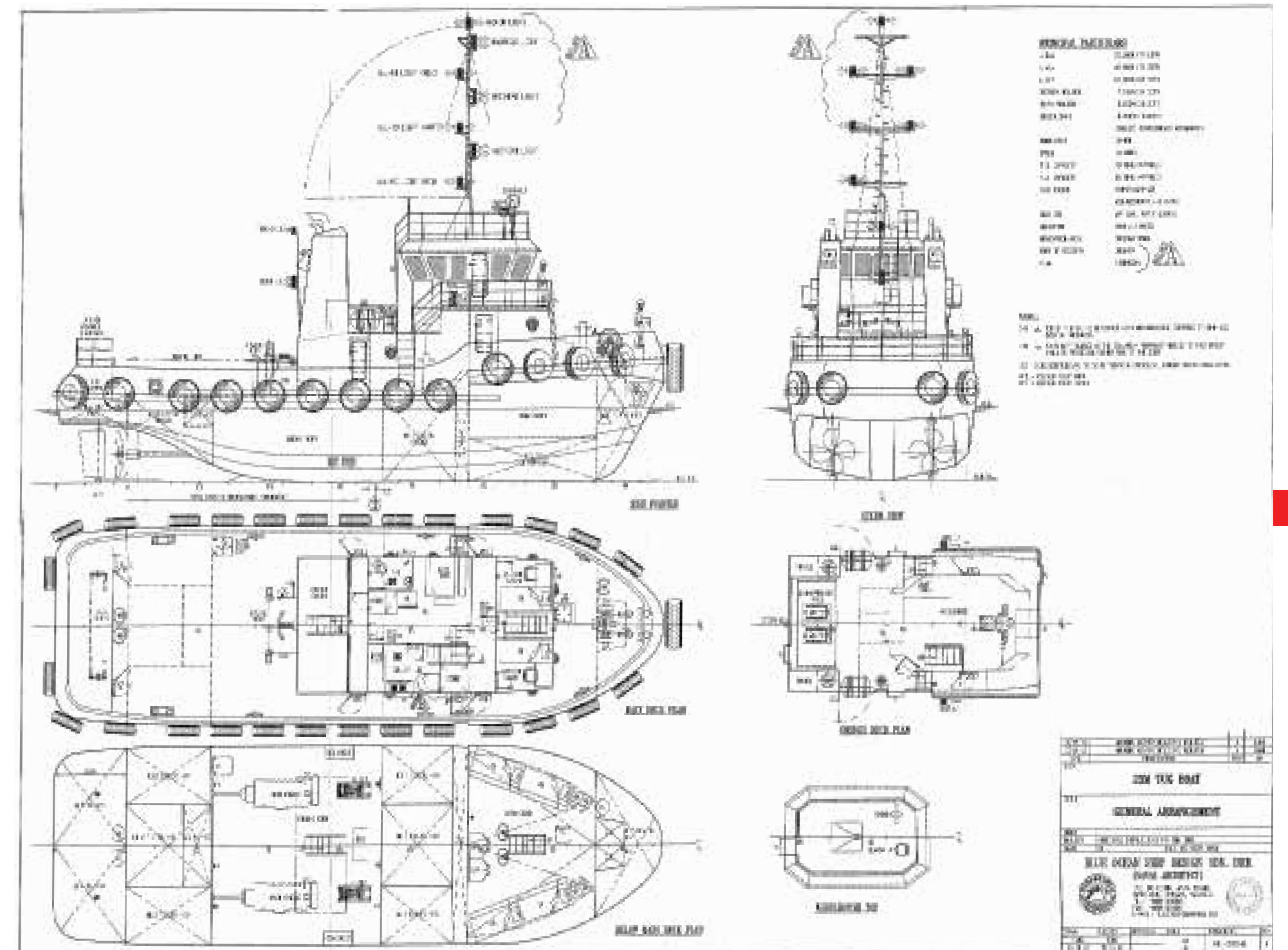



RIGEL X

FLAT TOP BARGE

PRINCIPAL PARTICULARS

VESSEL TYPE	FLAT TOP
BARGE	
SHAPE	SHIP SHAPE
YEAR OF BUILT	2004
PLACE OF BUILT	INDONESIA
FLAG	PANAMA
CLASS	RINA
GRT	4,781 TONS
NRT	1,434 TONS

PRINCIPAL DIMENSIONS

LOA	106.24 MTRS
BREADTH MOULDED	27.43 MTRS
DEPTH MOULDED	6.71 MTRS
DRAFT MOULDED	5.229 MTRS

CARGO CAPACITY

DEADWEIGHT	11,155.50 TONS
SUMMER TONNAGE	10,700 TONS
TROPICAL TONNAGE	11,000 TONS

DECK PARTICULARS

CLEAR DECK AREA	96.0 MTRS x 24.0 MTRS
DECK STRENGTH	15 T/M2

OTHER PARTICULARS

DOORS	BOTH SIDES, MIDSHIP
SIDEWALL HEIGHT	4 MTRS
ANCHOR	YES - AFT

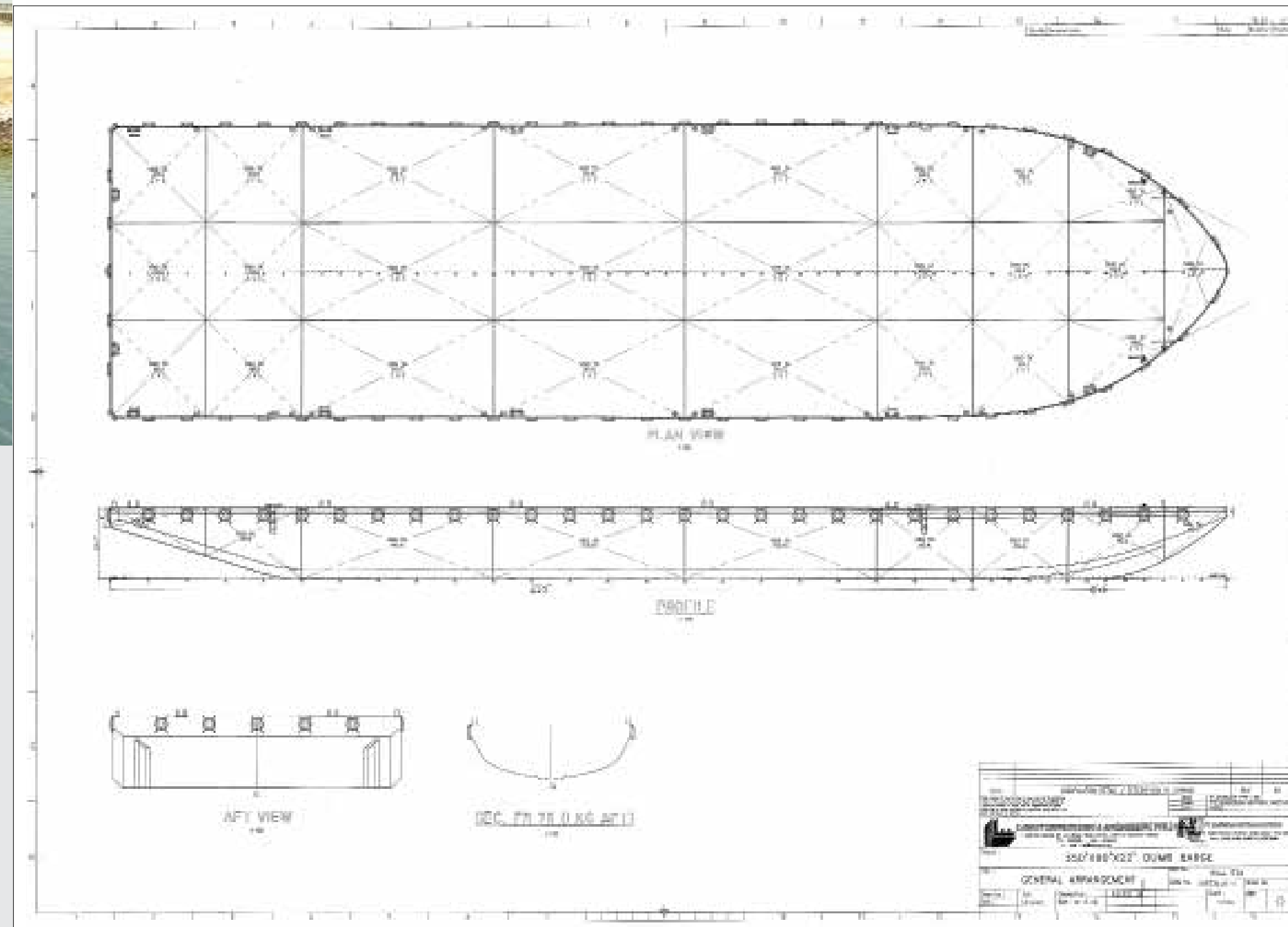



ARIES V

FLAT TOP BARGE

PRINCIPAL PARTICULARS

VESSEL TYPE	FLAT TOP BARGE
SHAPE	SHIP SHAPE
YEAR OF BUILT	2013
PLACE OF BUILT	CHINA
FLAG	PANAMA
CLASS	RINA
GRT	2,144 TONS
NRT	643 TONS

PRINCIPAL DIMENSIONS

LOA	82.30 MTRS
BREADTH MOULDED	21.40 MTRS
DEPTH MOULDED	4.90 MTRS
DRAFT MOULDED	3.20 MTRS

CARGO CAPACITY

DEADWEIGHT	5,500 TONS
SUMMER	4,860 TONS
TROPICAL	5,100 TONS

DECK PARTICULARS

CLEAR DECK AREA	73.2 MTRS X 19.1 MTRS
DECK STRENGTH	7T/M2

OTHER PARTICULARS

DOORS	BOTH SIDES, MIDSHIP
SIDEWALL HEIGHT	4 MTRS
ANCHOR	YES - FORWARD

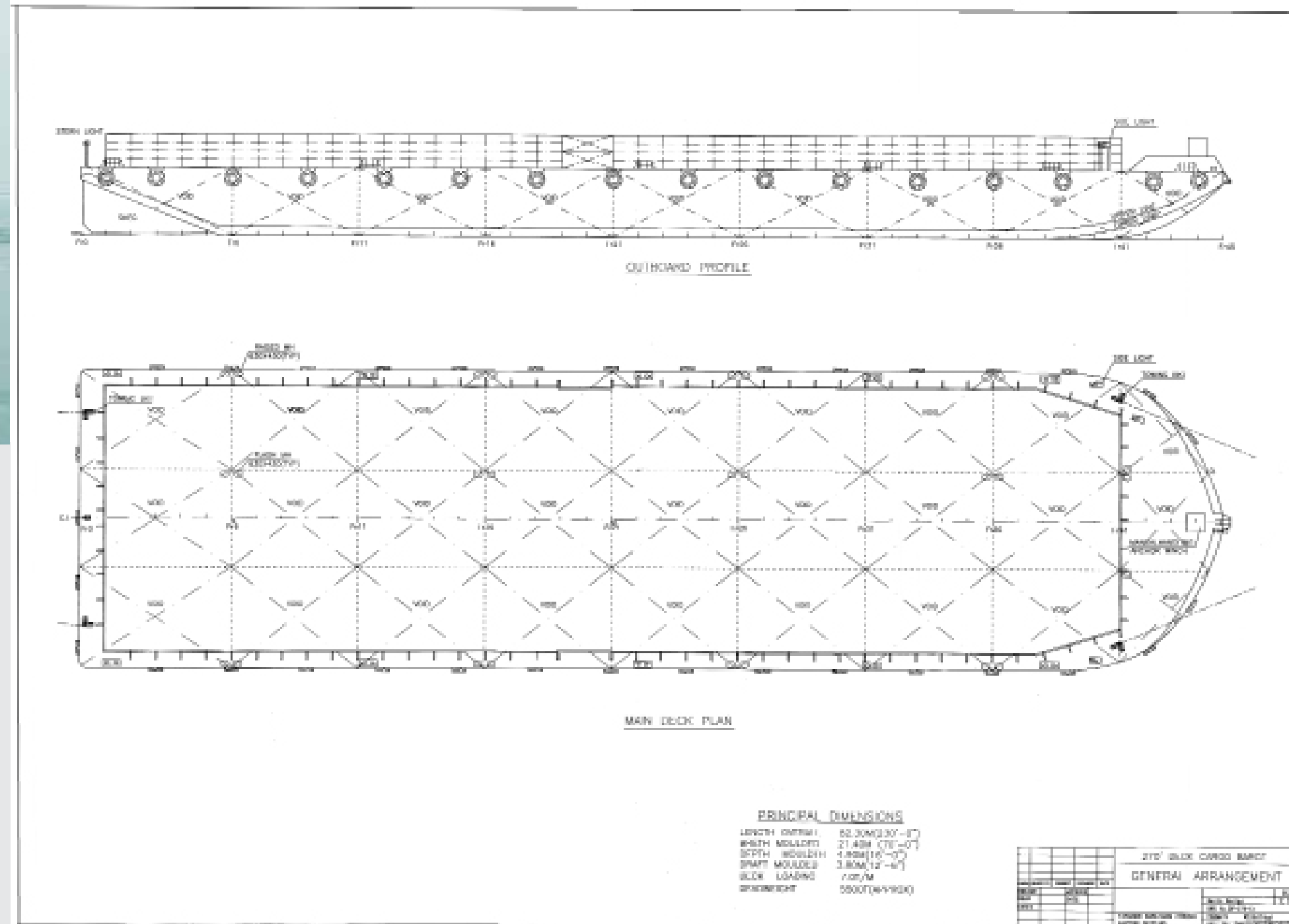



CAPELLA III

SPUD BARGE

PRINCIPAL PARTICULARS

VESSEL TYPE	SPUD BARGE
SHAPE	BOX
YEAR OF BUILT	2014
PLACE OF BUILT	BAHRAIN
FLAG	PANAMA
CLASS	RINA
GRT	979 TONS
NRT	293 TONS
DEADWEIGHT	2,406 TONS

PRINCIPAL DIMENSIONS

LOA	52.67 MTRS
BREADTH MOULDED	18.29 MTRS
DEPTH MOULDED	3.96 MTRS
DRAFT MOULDED	3.22 MTRS
LIGHT DRAFT	0.70 MTRS

BARGE MOORING SYSTEM

SPUDS	4 NOS
SPUD DIAMETER	83 CMTRS
SPUD LENGTH	22 MTRS
4 POINT MOORING SYSTEM	YES
SPUD WINCHES	4 X 15 TONS
WINCHES SPECIFICATION OF SPUDS	ELECTRO HYDRAULIC, SINGLE DRUM WINCHES
ANCHOR	4 NOS - 2,030 KGS EACH
ANCHOR WINCHES	4 X 10 TONS
ANCHOR WIRE LENGTH	200 MTRS
POWER GENERATOR	2 X PERKINS @ 1500 RPM
POWER GENERATOR CAPACITY	2 X 80 KVA

DECK PARTICULARS

DECK STRENGTH	15 T/M2
DECK AREA	APPROX. 900 M2

OTHER PARTICULARS

FRESH WATER TANK	5 TONS
------------------	--------

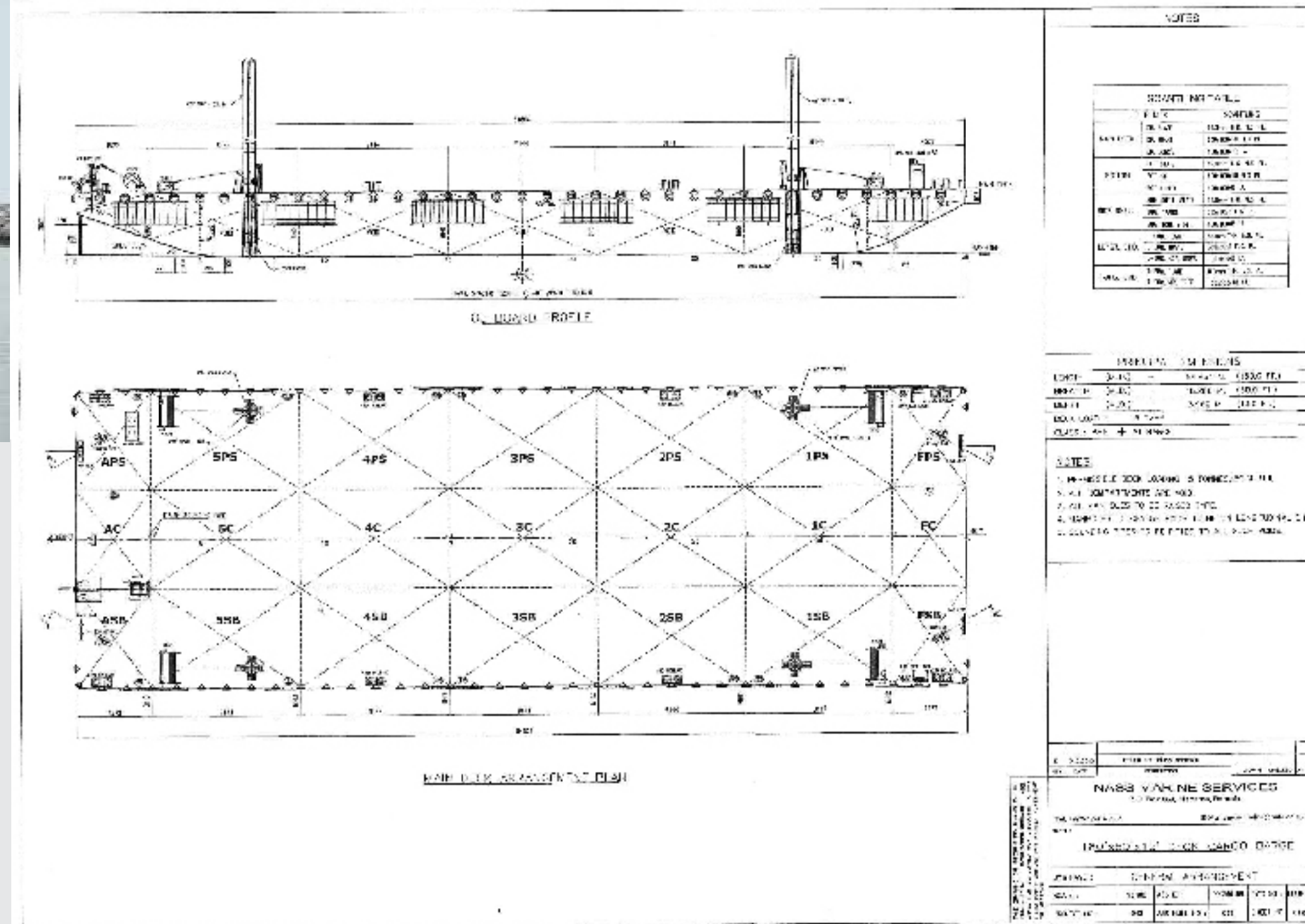



POLLUX XX

TUG BOAT

PRINCIPAL PARTICULARS

YEAR OF BUILT	2009
BUILDER	MALAYSIA
FLAG	PANAMA
CLASS	RINA
IMO NO	9506992
CALL SIGN	HP8271
GRT	317 TONS
NRT	96 TONS
ACCOMMODATION	14 MEN

MACHINERY

MAIN ENGINES	CUMMINS
POWER	2 X 1600 BHP
GENERATORS	VOLVO PENTA AB 100 KVA
PROPELLERS	2 X 4 BLADES
GEAR BOX	TWINDISC NICO
OILY WATER SEPARATOR	YES
SEWAGE PLANT	YES
BOW THRUSTER	NO
BOLLARD PULL	41 TONS

PRINCIPAL DIMENSIONS

LOA	28.93 MTRS
BREADTH	9.50 MTRS
DEPTH	4.20 MTRS
DRAFT	3.20 MTRS

TANK CAPACITIES

DIESEL FUEL OIL	200 TONS
POTABLE WATER	36 TONS
BALLAST	12 TONS
LUB OIL	2.24 TONS

CONSUMPTION

FUEL TYPE	MGO
DAILY CONSUMPTION :	
FREE RUNNING	4,000 LTRS
TOWING EMPTY BARGE	4,500 LTRS
TOWING LOADED BARGE	4,800 LTRS
IDLE	500 LTRS

SPEED

MAX. SPEED	10 KNOTS
TOWING SPEED :	
ECO SPEED	3.5 KNOTS
FULL SPEED	4.5 KNOTS

DECK EQUIPMENT

ANCHOR WINDLASS	YES
TOWING WINCH	YES
TOWING HOOK	40 TON CAPACITY

NAVIGATION EQUIPMENT

AUTOPILOT	YES
GPS	YES
RADAR	YES
ECHO SOUNDER	YES
VHF RADIO	YES
MF RADIO	YES
SURVIVAL RADIO	YES
SSB RADIO	YES
EPIRB	YES
NAVTEX	YES
INMARSAT-C	YES
GMDSS	YES
MAGNETIC COMPASS	YES
AIS	YES
SART	YES

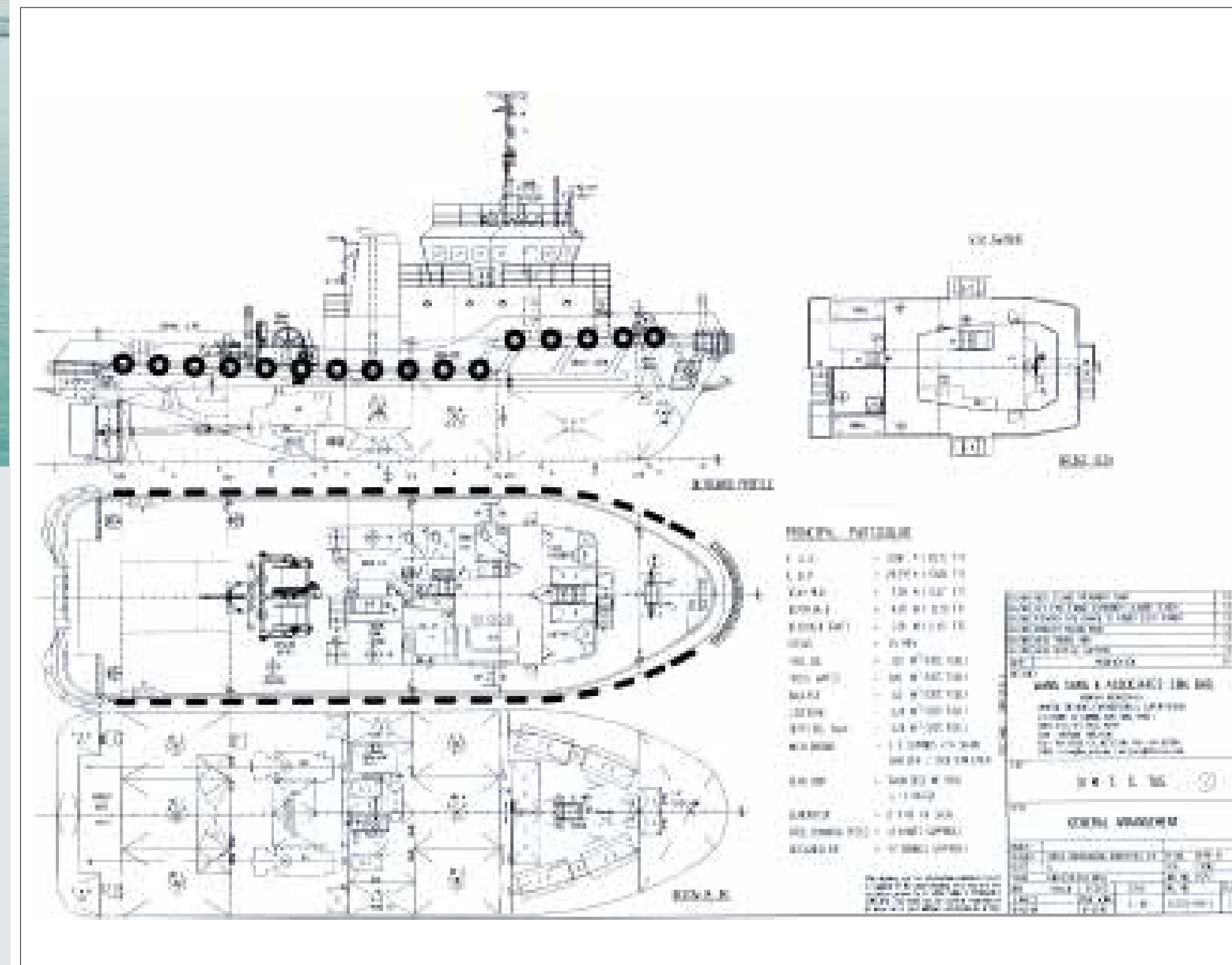



PHANTOS XX

TUG BOAT

PRINCIPAL PARTICULARS

YEAR OF BUILT	2011
PLACE OF BUILT	CHINA
FLAG	PANAMA
CLASS	RINA
IMO NO	9573036
CALL SIGN	HO9292
GRT	249 TONS
NRT	74 TONS
ACCOMMODATION	14 MEN

MACHINERY

MAIN ENGINES	YANMAR
POWER	2 X 1600 BHP
GENERATORS	VOLVO
	PENTA AB
	(2 X 187.7 HP)
PROPELLERS	2 X 4 BLADES
GEAR BOX	YANMAR
	MARINE
OILY WATER SEPARATOR	YES
SEWAGE PLANT	YES
BOW THRUSTER	YES
BOLLARD PULL	40 TONS

PRINCIPAL DIMENSIONS

LOA	27.49 MTRS
BREADTH	9.00 MTRS
DEPTH	4.16 MTRS
DRAFT	3.50 MTRS

TANK CAPACITIES

DIESEL FUEL OIL	200 TONS
POTABLE WATER	36 TONS
BALLAST	12 TONS
LUB OIL	2.24 TONS

CONSUMPTION

FUEL TYPE	MGO
DAILY CONSUMPTION:	
FREE RUNNING	4800 LTRS
TOWING EMPTY BARGE	5000 LTRS
TOWING LOADED BARGE	5300 LTRS
IDLE	500 LTRS

SPEED

MAX. SPEED	10 KNOTS
TOWING SPEED:	
ECO SPEED	4.5 KNOTS
FULL SPEED	4.0 KNOTS

DECK EQUIPMENT

ANCHOR WINDLASS	YES
TOWING WINCH	YES
TOWING HOOK	50 TON

NAVIGATION EQUIPMENT

AUTOPILOT	YES
GPS	YES
RADAR	YES
ECHO SOUNDER	YES
VHF RADIO	YES
SSB RADIO	YES
EPIRB	YES
NAVTEX	YES
INMARSAT-C	YES
GMDSS	YES
MAGNETIC COMPASS	YES
AIS	YES

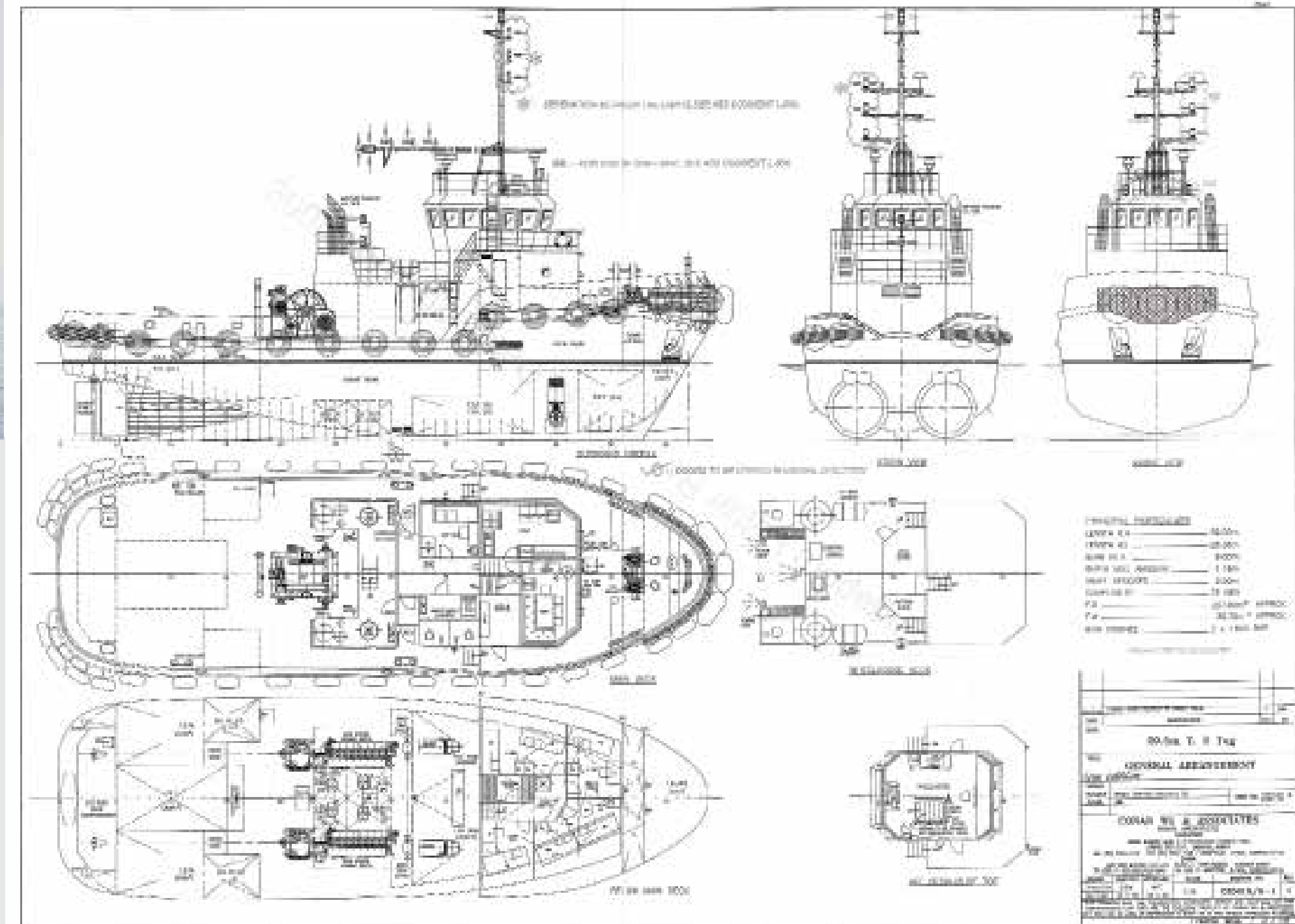



ARCHER V

FLAT TOP BARGE

PRINCIPAL PARTICULARS

VESSEL TYPE	FLAT TOP BARGE
SHAPE	BOX
YEAR OF BUILT	2014
PLACE OF BUILT	CHINA
FLAG	PANAMA
CLASS	RINA
GRT	2,314 TONS
NRT	694 TONS

PRINCIPAL DIMENSIONS

LOA	76.20 MTRS
BREADTH MOULDED	24.38 MTRS
DEPTH MOULDED	4.88 MTRS
DRAFT MOULDED	3.62 MTRS

CARGO CAPACITY

DEADWEIGHT	4,905 TONS
SUMMER TONNAGE	4,800 TONS
TROPICAL TONNAGE	4,900 TONS

DECK PARTICULARS

CLEAR DECK AREA	65 MTRS X 20 MTRS
DECK STRENGTH	20 T/M2

OTHERS

SIDE STANCHIONS / HEIGHT	YES STEEL PIPES / 1.2 MTRS
STANCHIONS HEIGHT	1.2 MTRS
ANCHOR / WIRE LENGTH	YES - FORWARD / 200 MTRS
DAMAGE CONTROL BOX	YES
SALVAGE PUMP	YES
DELTA PLATE RECOVERY WINCH	YES

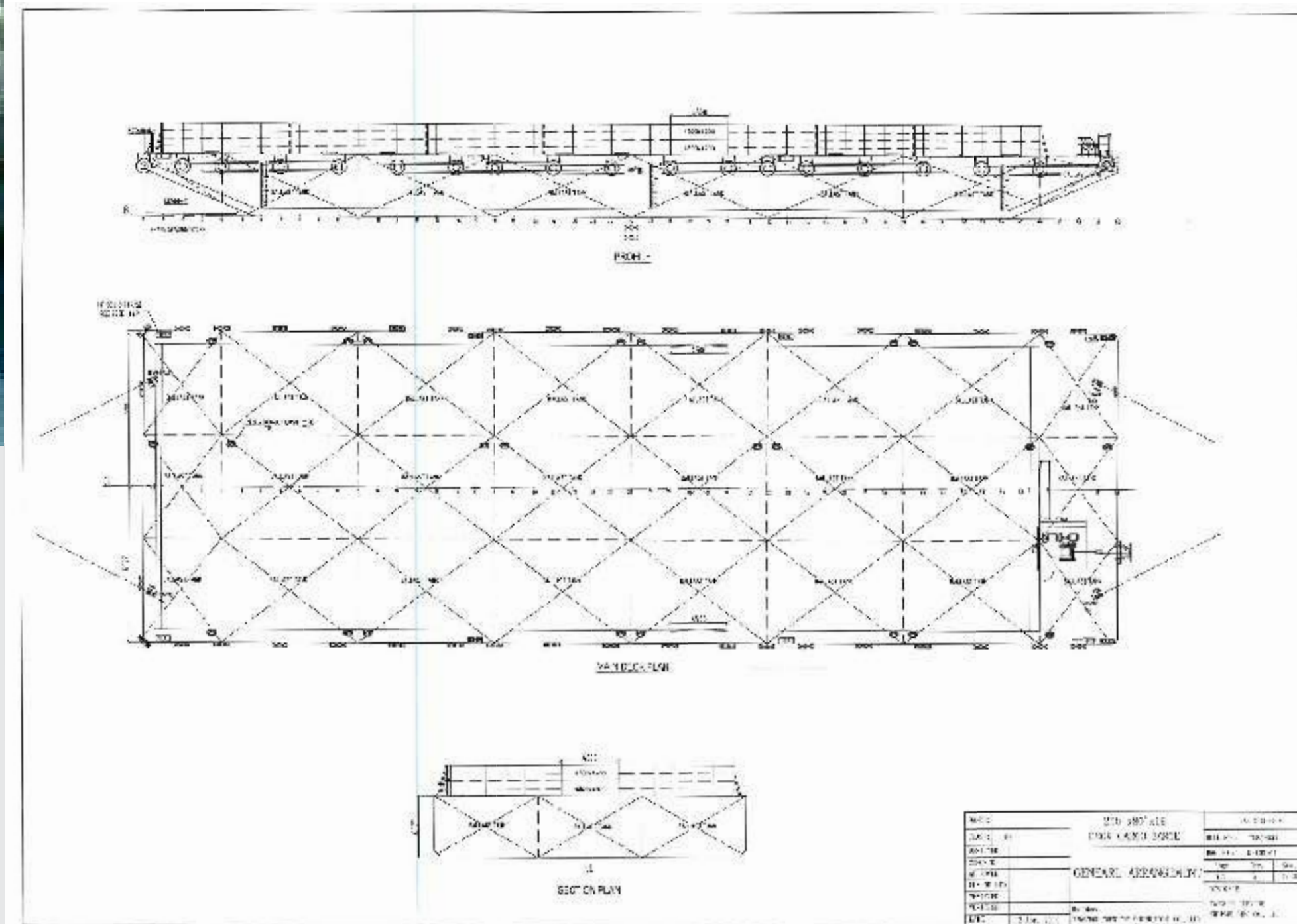

NO.	DESCRIPTION	DATE
1	DESIGN	2014
2	CONSTRUCTION	2014
3	OPERATION	2014
4	REPAIR	2014
5	RENOVATION	2014
6	DISMANTLING	2014



ANTARES IV

SPUD BARGE

PRINCIPAL PARTICULARS

VESSEL TYPE	SPUD BARGE
SHAPE	BOX
YEAR OF BUILT	2014
PLACE OF BUILT	BAHRAIN
FLAG	PANAMA
CLASS	RINA
GRT	979 TONS
NRT	293 TONS
DEADWEIGHT	2,406 TONS

PRINCIPAL DIMENSIONS

LOA	52.67 MTRS
BREADTH MOULDED	18.29 MTRS
DEPTH MOULDED	3.96 MTRS
DRAFT MOULDED	3.22 MTRS
LIGHT DRAFT	0.70 MTRS

BARGE MOORING SYSTEM

SPUDS	4 NOS
SPUD DIAMETER	78 CMTRS
SPUD LENGTH	18 MTRS
4 POINT MOORING SYSTEM	YES
SPUD WINCHES	4 X 15 TONS
WINCHES SPECIFICATION OF SPUDS	ELECTRO HYDRAULIC, SINGLE DRUM WINCHES
ANCHOR	4 NOS - 2,030 KGS EACH
ANCHOR WINCHES	4 X 10 TONS
ANCHOR WIRE LENGTH	200 MTRS
POWER GENERATOR	2 X PERKINS @ 1500 RPM
POWER GENERATOR CAPACITY	2 X 80 KVA

DECK PARTICULARS

DECK STRENGTH	15 T/M2
DECK AREA	APPROX. 775 M2

OTHER PARTICULARS

FRESH WATER TANK	5 TONS
------------------	--------

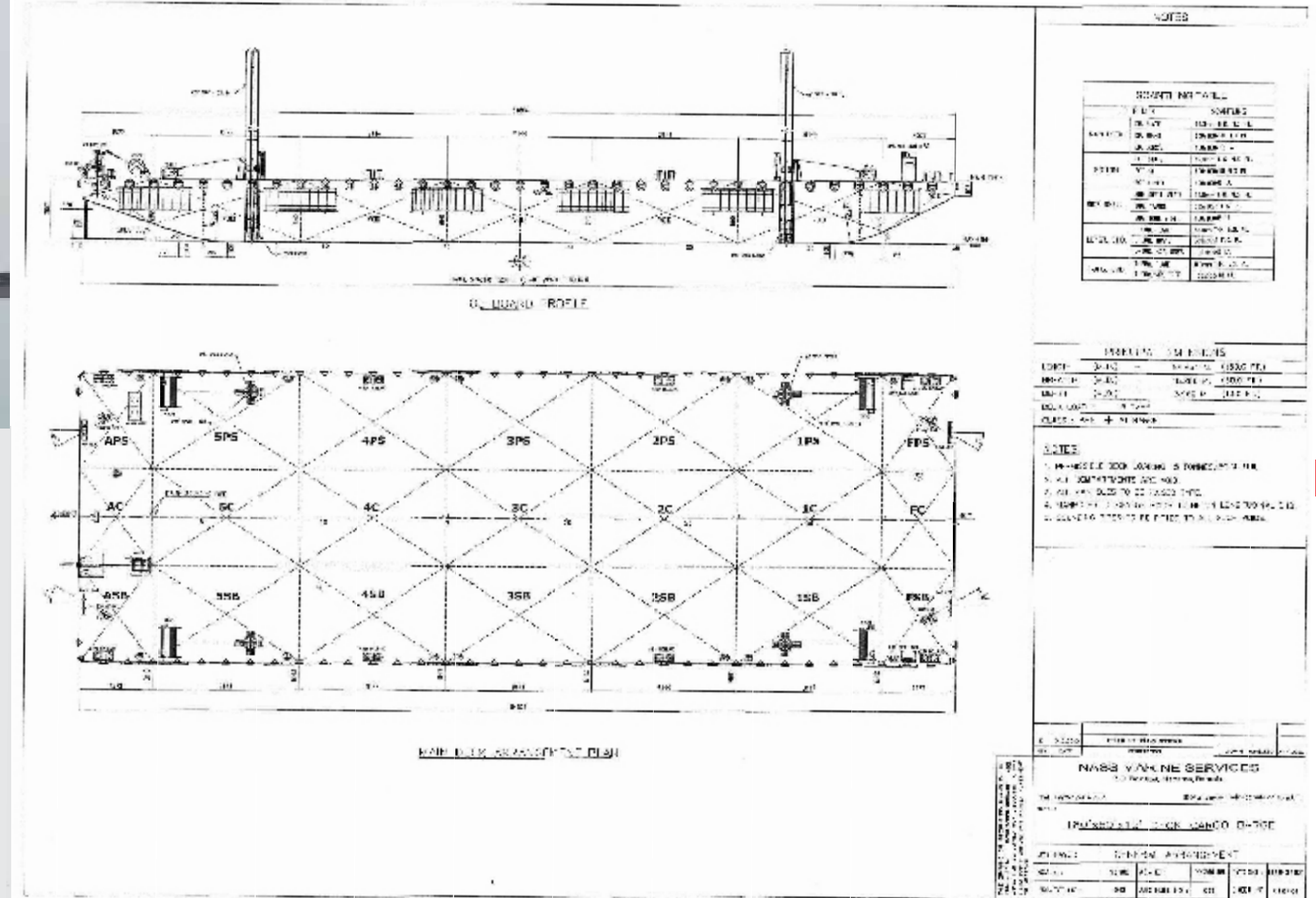



PISCES XX

TUG BOAT

PRINCIPAL PARTICULARS

YEAR OF BUILT	2011
BUILDER	MALAYSIA
FLAG	PANAMA
CLASS	RINA
IMO NO	9519456
CALL SIGN	HO6943
GRT	298 TONS
NRT	90 TONS
ACCOMMODATION	14 MEN

MACHINERY

MAIN ENGINES	CUMMINS
POWER GENERATORS	2 X 1600 BHP CUMMINS (2 X 100 KVA)
PROPELLERS	2 X 4 BLADES
GEAR BOX	TWINDISC NICO CO LTD
OILY WATER SEPARATOR	YES
SEWAGE PLANT	YES
BOW THRUSTER	NO
BOLLARD PULL	40 TONS

PRINCIPAL DIMENSIONS

LOA	32.00
MTRS	
BREADTH	9.14 MTRS
DEPTH	4.20 MTRS
DRAFT	3.50 MTRS

TANK CAPACITIES

DIESEL FUEL OIL	212 TONS
POTABLE WATER	33 TONS
BALLAST	24 TONS
LUB OIL	3.5 TONS

CONSUMPTION

FUEL TYPE	MGO
DAILY CONSUMPTION:	
FREE RUNNING	4000 LTRS
TOWING EMPTY BARGE	4500 LTRS
TOWING LOADED BARGE	4800 LTRS
IDLE	500 LTRS

SPEED

MAX. SPEED	10 KNOTS
TOWING SPEED:	
ECO SPEED	3.5 KNOTS
FULL SPEED	4.5 KNOTS

DECK EQUIPMENT

ANCHOR WINDLASS	YES
TOWING WINCH	YES
TOWING HOOK CAPACITY	40 TON

NAVIGATION EQUIPMENT

AUTOPILOT	YES
GPS	YES
RADAR	YES
ECHO SOUNDER	YES
VHF RADIO	YES
SSB RADIO	YES
EPIRB	YES
NAVTEX	YES
INMARSAT-C	YES
GMDSS	YES
MAGNETIC COMPASS	YES
AIS	YES

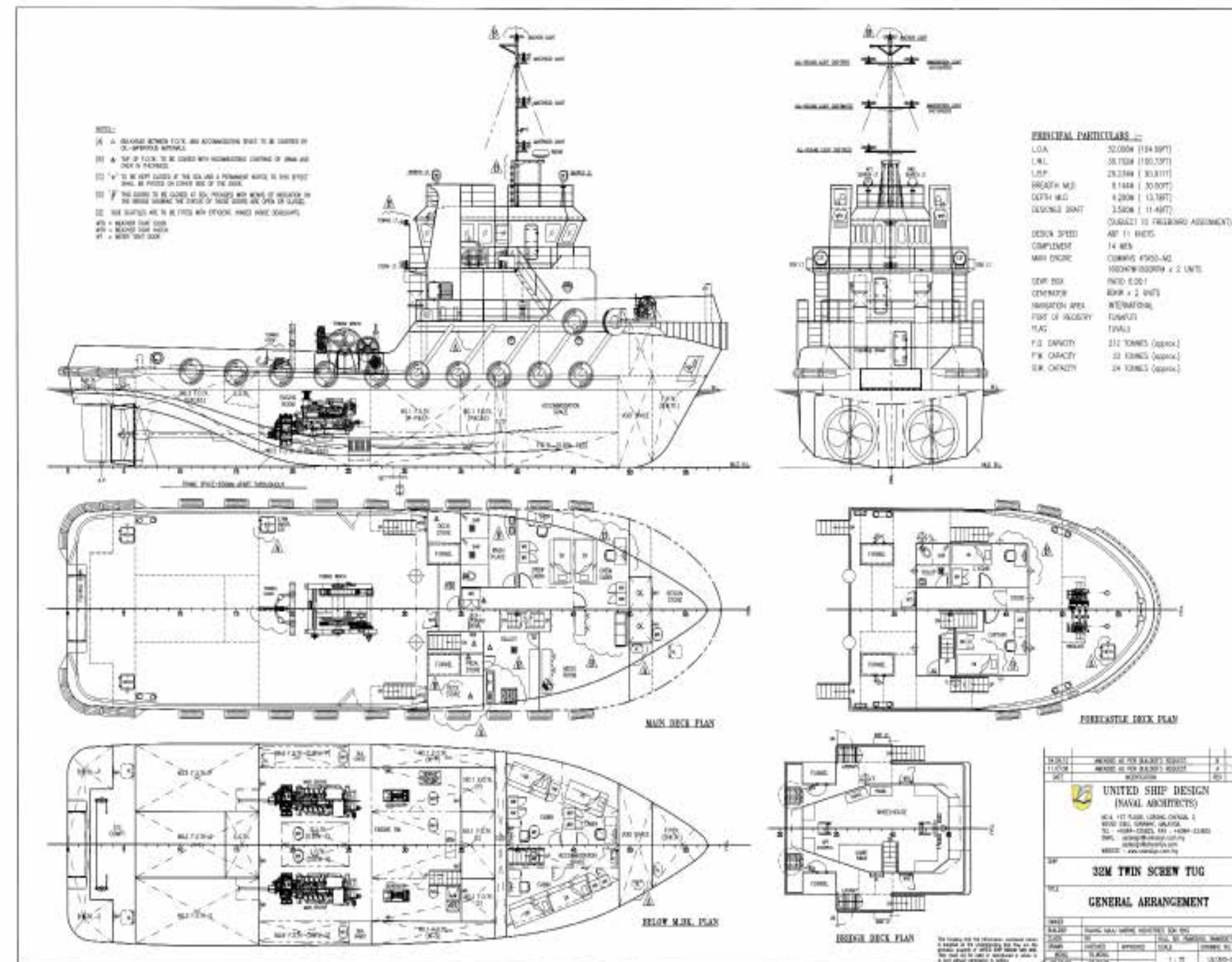



PROCYON XX

TUG BOAT

PRINCIPAL PARTICULARS

YEAR OF BUILT	2014
PLACE OF BUILT	MALAYSIA
FLAG	PANAMA
CLASS	RINA
IMO NO	9761009
CALL SIGN	A7EU
GRT	273 TONS
NRT	82 TONS
ACCOMMODATION	12 MEN

MACHINERY

MAIN ENGINES	
MITSUBISHI	
POWER	2 X
1017 BHP	
GENERATORS	CUMMINS (2 X 78 KVA)

PROPELLERS	2 X 4 BLADES
GEAR BOX	HITACHI
	NGN 91 BL

OILY WATER SEPARATOR	YES
SEWAGE PLANT	YES
BOW THRUSTER	YES
BOLLARD PULL	25 TONS

PRINCIPAL DIMENSIONS

LOA	28.00 MTRS
BREADTH	8.60 MTRS
DEPTH	4.12 MTRS
DRAFT	3.50 MTRS

TANK CAPACITIES

DIESEL FUEL OIL	192 TONS
POTABLE WATER	66 TONS
BALLAST	67 TONS
LUB OIL	

CONSUMPTION

FUEL TYPE	MGO
DAILY CONSUMPTION:	
FREE RUNNING	2800 LTRS
TOWING EMPTY BARGE	3500 LTRS
TOWING LOADED BARGE	3800 LTRS
IDLE	300 LTRS

SPEED

MAX. SPEED	10 KNOTS
TOWING SPEED:	
ECO SPEED	4.5 KNOTS
FULL SPEED	4.0 KNOTS

DECK EQUIPMENT

ANCHOR WINDLASS	YES
TOWING WINCH	YES
TOWING HOOK	25
TON	

NAVIGATION EQUIPMENT

AUTOPILOT	YES
GPS	YES
RADAR	YES
ECHO SOUNDER	YES
VHF RADIO	YES
SSB RADIO	YES
EPIRB	YES
NAVTEX	YES
INMARSAT-C	YES
GMDSS	YES
MAGNETIC COMPASS	YES
AIS	YES

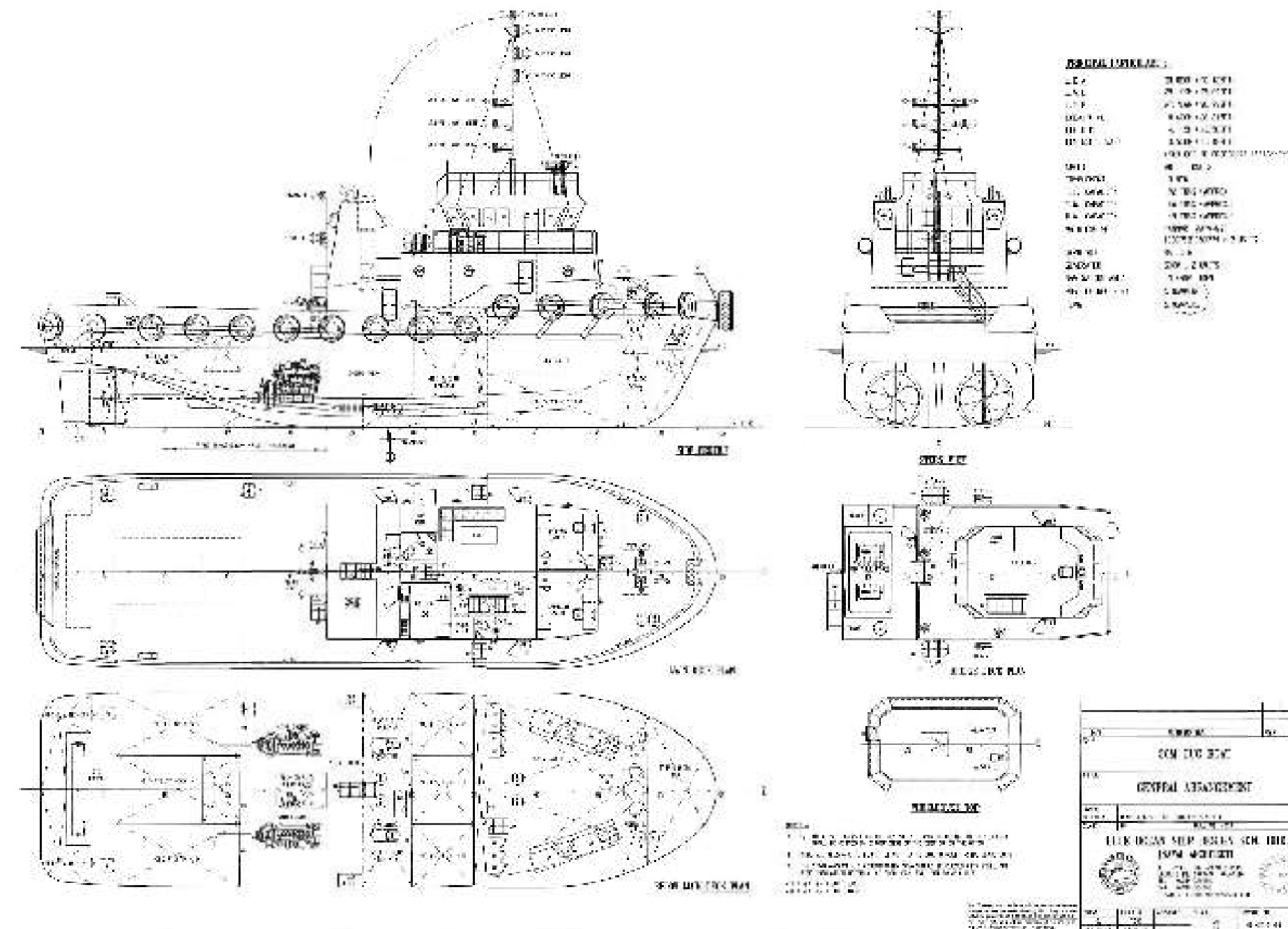



ALLHUDAD

LANDING CRAFT

DIMENSION

LENGTH O.A.	64.0 m
BEAM O.A.	14.63
DEPTH (EXT)	4.5 m
DRAUGHT (MINIMUM)	1.68 m
LIGHT SHIP DISPLACEMENT	1078.66 T
LOAD DISPLACEMENT	2587.8 T

CARGO / DECK

ANCHORS	1	740 Kg Stockless
ANCHOR WINDLASS		HY RAW C36 15T
ANCHOR CHAIN		495 m @ 36mm dia
CAPSTAN		05 Ton
Deck Space		537.4 m ³
Deck Load Capacity		79 TEU (1347 T)
Deck Strength		8 T / m ²
Ramp Door Dimensions		9.00 m x 8.15 m
Ramp Door Safe		SWL 60 T

TANK CAPACITY

FUEL OIL	1229.8 m ³
FRESH WATER	64.3 m ³
LUBRICATION OIL	7.7 m ³
DIRTY OIL	12.3 m ³
HYDRAULIC OIL	7.5 m ³
SEWAGE	3.6 m ³
BILGE WATER	14.3 m ³

PROPULSION SYSTEM

MAIN ENGINES	2 X CUMMINS K 38, 1000HP @ 1800rpm
TOTAL POWER	1000 x 2(1492kw)
FORCED VENTILATION	
BOW THRUSTER	1 unit Cummins KTA 19M3 600HP @ 1800rpm
PROPELLER DIAMETER	2000 mm

PERFORMANCE

SPEED AHEAD	10 Knots
AUXILIARY EQUIPMENT	
GENERATOR SETS	3 X Cummins,@ 150KW,415V 50Hz , 3P
BILGE PUMPS	65 m ³ /HR @ 60 m
FUEL OIL CARGO PUMPS	150 m ³ /HR @ 60 m
DIRTY OIL PUMP	06 m ³ /HR @ 50 m
FRESHWATER CARGO PUMP	80 m ³ / Hr. @ 60 m
SEWAGE PLANT	Fitted # ISS-25N-600,1.75T Day
FUEL OIL TRANSFER PUMP	10 m ³ / Hr. @ 30 m
GS & FIRE PUMP	80 m ³ / Hr. @ 60 m

NAUTICAL AND COMMUNICATION EQUIPMENT

RADAR	X-Band (IRC)
COMPASSES	01 No (Lilley & Gillie)
ECHO SOUNDER	01 No (Samyung)
GPS	01 No (JRC)
AIS	01 No (JRC)
VHF	02 No (NSR)
GMDSS	Inmarsat C - A1,A2,A3
SART	AIS SART 02 Nos.
NAVTEX	01 Nos. (NSR)
EPIRB	01 Nos. (GME) 406 MHZ

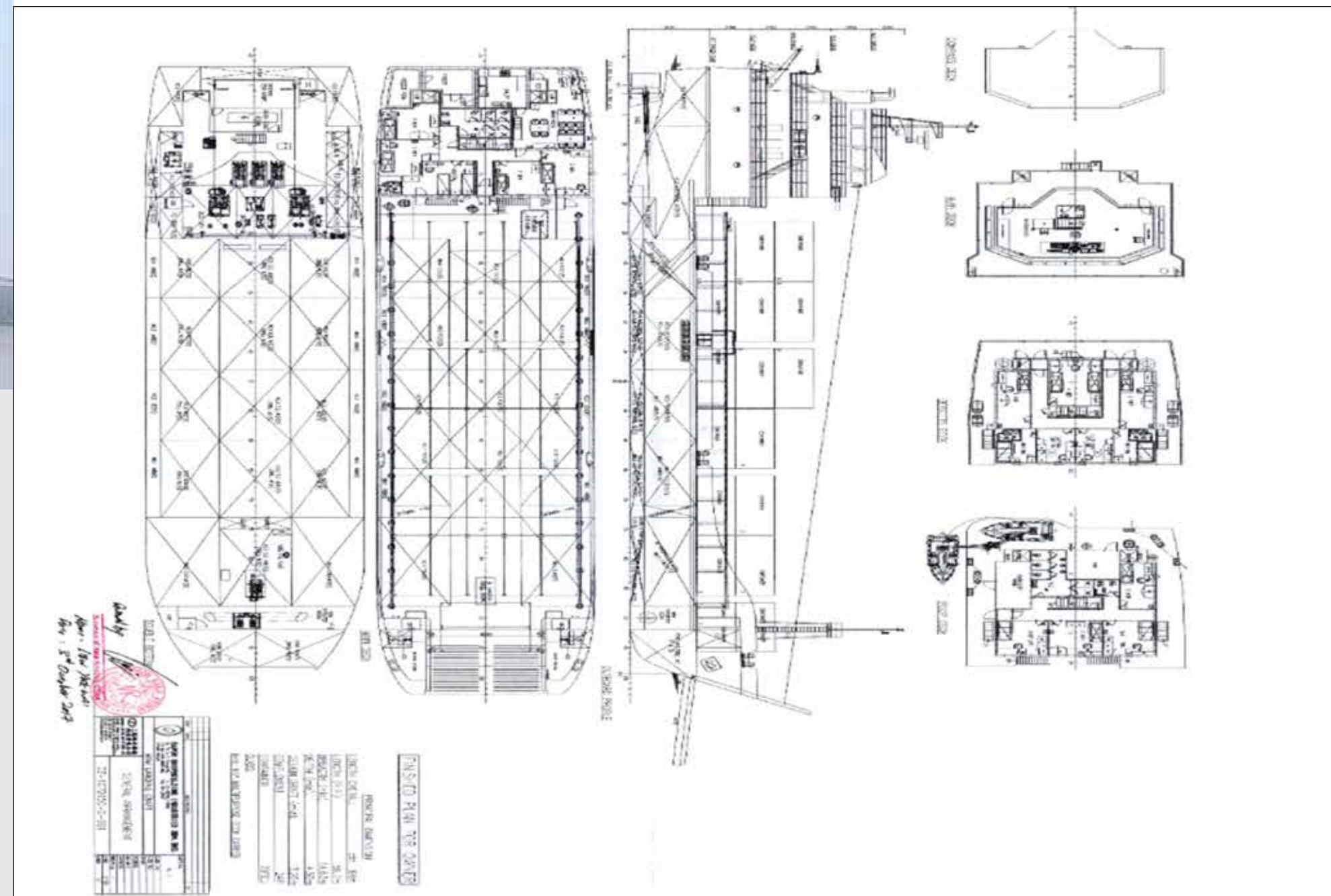



ASSOMPTION STAR

LANDING CRAFT

DIMENSION

LENGTH O.A.	88.58m
BEAM O.A.	16.80m
DEPTH (EXT)	4.20 m
DRAUGHT (MINIMUM)	2.80 m
LIGHT SHIP DISPLACEMENT	1023.45 T
LOAD DISPLACEMENT	3014.00 T

PRINCIPAL PARTICULARS

VESSEL TYPE	ASSOMPTION STAR
FLAG	SAINT KITTS & NEVIS
PORT OF REGISTRY	BASSETERRE
CLASS	RINA
MMSI NO	341368001
OFFICIAL NO	SKN 1004806
I M O NO	9808936
CALL SIGN	V4PK5
TYPE	DECK CARGO SHIP
G R T	1878
N R T	563

PRINCIPAL DIMENSIONS

L O A (with additional obj)	88.58M
L B P	73.50M
BREADTH	16.80M
DEPTH MOULDED	4.20M
MAX DRAFT	2.80M

DECK PARTICULARS

DECK AREA 7	02M2
DEAD WEIGHT	2000MT

CARGO CAPACITY

LIGHT SHIP	1023.45MT
BOLLARD PULL	N/A
DISPLACEMENT	3014.00MT
YEAR OF BUILD /REBUILD	2015 / 2017

OTHER PARTICULARS

NAME OF BUILDER	NANTONG TONGSHENG SHIPBUILDING Co.Ltd /	CHINA
DATE OF KEEL LAID	01st DECEMBER	2015w
SPEED		7.0KTS
MAIN ENGINE	CUMMINS	2X746KW
AUXILLARY ENG	CUMMINS	2X100KW
DIESEL OIL CAPACITY		50 MT
FRESH WATER CAPACITY		150MT
ANCHORS	4X ANCHORS	(2XFWD + 2XAFT)
PROPELLERS	2 X FIXED PITCH	32

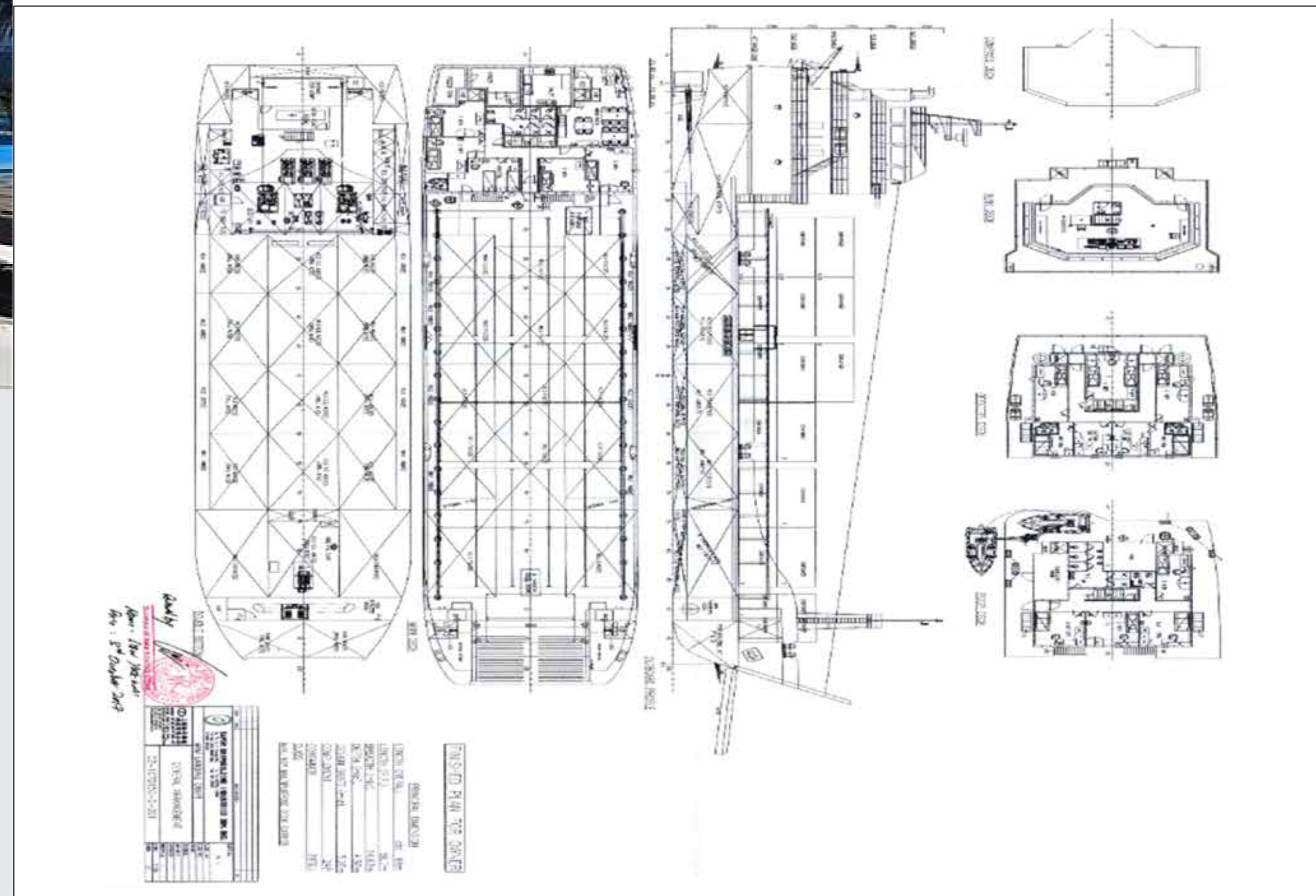



 **elegancia**
marine

A subsidiary of

 **Estithmar**
Holding استثمار القابضة